



**EMERGENCY
LIGHTING
SERIES**

目录 CONTENT



01-02 公司简介
COMPANY PROFILE

应急灯 EMERGENCY LIGHT

05 舱壁应急灯
BULKHEAD EMERGENCY LIGHT

06-10 安全出口指示灯
EXIT LIGHTS

11-12 LED应急射灯
LED SPOT EMERGENCY DOWNLIGHT

13 应急灯
EMERGENCY LIGHT

14-16 双头应急灯
TWIN HEAD EMERGENCY LIGHT

应急电池组 EMERGENCY BATTERY PACKS

驱动应急一体化 21
Combo Emergency battery pack

全功率应急电源 22-23
Full Emergency power battery pack

降功率应急电源 24-28
Non Full emergency driver

舱壁应急灯 Bulkhead Emergency Light

MODEL: WTE-09

FEATURES

- LIGHT BODY MADE FROM POLYCARBONAT
- LI-ION BATTERY
- LED SUPER BRIGHT
- HIGH LUMINOUS EFFICENCY, LOWER THERMAL
- DIFFUSIVITY TO PROVIDE UNIFORM & COMFORTABLE LIGHT LAYOUT
- STANDARD: CE, ROHS
- MSDS AVAILBLE

APPLICATIONS

OFFICE, SCHOOL, FACTORY, HOSPITAL...

SPECIFICATIONS

INPUT VOLTAGE: AC 100-280V 50/60HZ
POWER: 3W-8W
CCT: 5000K-6000K
LUMENS: 250-650LMS
BATTERY: 3.7V LITHIUM
MATERIAL: ABS PLASTIC + PC
COLOR RENDERING INDEX: 80
CHARGING TIME: ≥24 HOURS
EFFICIENCY ≥24 HOUS
WATERPROOF: IP65
SWICH TIME: 1S
LIGHTING SYSTEM: CONTINUOUS
WORKING TEMP: -20°C ~ +50°C



MODEL: WTE-12

FEATURES

- LIGHT BODY MADE FROM POLYCARBONAT
- LI-ION BATTERY
- LED SUPER BRIGHT
- HIGH LUMINOUS EFFICENCY, LOWER THERMAL
- DIFFUSIVITY TO PROVIDE UNIFORM & COMFORTABLE LIGHT LAYOUT
- STANDARD: CE, ROHS
- MSDS AVAILBLE

APPLICATIONS

OFFICE, SCHOOL, FACTORY, HOSPITAL...

SPECIFICATIONS

INPUT VOLTAGE: AC 85-265V 50/60HZ
LIGHT SOURCE: 62 PCS 2835 LED
CCT: 6500K
EMERGENCY POWER: 3W
BATTERY: 3.7V 2400MAH LITHIUM
MATERIAL: ABS PLASTIC
CHARGING TIME: ≥24 HOURS
EMERGENCY TIME: 2 HOURS
WORKING MODE: MAINTAINED ORNON-MAINTAINED
NSTALLATION: WALL MOUNTED/RECESSED MOUNTED

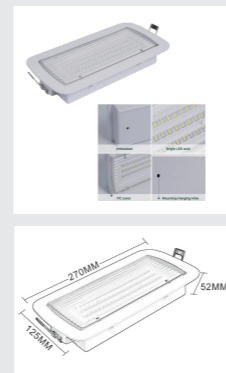

MODEL: WTE-035

FEATURES

- LIGHT BODY MADE FROM POLYCARBONAT
- LI-ION BATTERY
- LED SUPER BRIGHT
- HIGH LUMINOUS EFFICENCY, LOWER THERMAL
- DIFFUSIVITY TO PROVIDE UNIFORM & COMFORTABLE LIGHT LAYOUT
- STANDARD: CE, ROHS
- MSDS AVAILBLE

APPLICATIONS

OFFICE, SCHOOL, FACTORY, HOSPITAL...

SPECIFICATIONS

INPUT VOLTAGE: AC 85-265V 50/60HZ
POWER: 3W
BATTERY: 3.7V LITHIUM
EMERGENCY TIME: 1-3HOURS
MATERIAL: ABS PLASTIC + PC
CHARGING TIME: ≥24 HOURS
WATERPROOF: IP65
WORKING MODE: MAINTAINED ORNON-MAINTAINED



MODEL: EES-02

FEATURES

- LIGHT BODY MADE FROM IRON AND PLASTIC
- LIFEPO4 BATTERY
- LED SUPER BRIGHT
- HIGH LUMINOUS EFFICENCY, LOWER THERMAL
- DIFFUSIVITY TO PROVIDE UNIFORM & COMFORTABLE LIGHT LAYOUT
- STANDARD: CE, ROHS
- MSDS AVAILBLE

APPLICATIONS

OFFICE, SCHOOL, FACTORY, HOSPITAL...

SPECIFICATIONS

INPUT VOLTAGE: AC 220V 50/60HZ
POWER: 3W
BATTERY: LIFEPO4 3.2V 1800MAH
MATERIAL: IRON+PLASTIC
CHARGING TIME: ≥24 HOURS
EMERGENCY TIME: ≥3 HOURS
PRODUCT SIZE: 385*157*120MM
INSTALLING TYPE: WALL MOUNTED/
CEILING MOUNTED

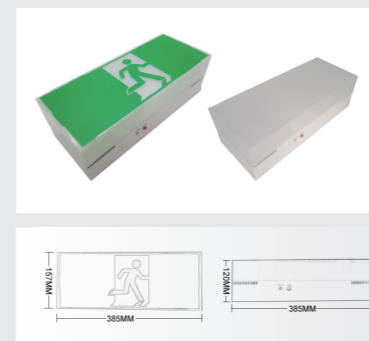

安全出口指示灯 Exit Lights

EMERGENCY LIGHT

MODEL: EES-01

FEATURES

- LIGHT BODY MADE FROM IRON AND ACRYLIC
- LI-ION/NI-CD BATTERY
- LED SUPER BRIGHT
- HIGH LUMINOUS EFFICENCY, LOWER THERMAL
- DIFFUSIVITY TO PROVIDE UNIFORM & COMFORTABLE LIGHT LAYOUT
- STANDARD: CE, ROHS
- MSDS AVAILBLE

APPLICATIONS

OFFICE, SCHOOL, FACTORY, HOSPITAL...

SPECIFICATIONS

INPUT VOLTAGE: AC 95-265V 50/60HZ
POWER: 2W/3W
BATTERY: LI-ION 3.7V 1800MAH NI-CD 3.6V 1500MAH
MATERIAL: IRON+ACRYLIC
CHARGING TIME: ≥24 HOURS
EMERGENCY TIME: ≥3 HOURS
OPERATION: MAINTAINED/NON-MAINTAINED
ILLUMINATION: GREEN OR RED OPTIONAL
PRODUCT SIZE: 390*190*60MM
INSTALLING TYPE: WALL MOUNTED/SIDE MOUNTED

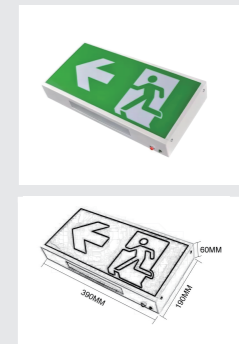

MODEL: EES-01B

FEATURES

- LIGHT BODY MADE FROM IRON AND PLASTIC
- LI-ION BATTERY
- LED SUPER BRIGHT
- HIGH LUMINOUS EFFICENCY, LOWER THERMAL
- DIFFUSIVITY TO PROVIDE UNIFORM & COMFORTABLE LIGHT LAYOUT
- STANDARD: CE, ROHS
- MSDS AVAILBLE

APPLICATIONS

OFFICE, SCHOOL, FACTORY, HOSPITAL...

SPECIFICATIONS

INPUT VOLTAGE: AC 95-265V 50/60HZ
POWER: 3W
BATTERY: LI-ION 3.7V 2200MAH
MATERIAL: IRON+ACRYLIC
CHARGING TIME: ≥12 HOURS
EMERGENCY TIME: ≥2 HOURS
OPERATION: MAINTAINED/NON-MAINTAINED
ILLUMINATION: GREEN OR RED OPTIONAL
PRODUCT SIZE: 600*185*60MM
INSTALLING TYPE: WALL MOUNTED

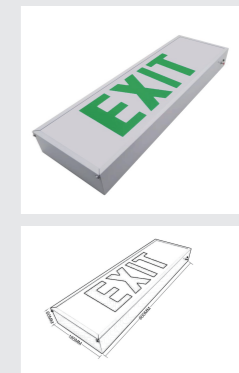

MODEL: EES-10

FEATURES

- LIGHT BODY MADE FROM IRON AND ACRYLIC
- LI-ION BATTERY
- LED SUPER BRIGHT
- HIGH LUMINOUS EFFICENCY, LOWER THERMAL
- DIFFUSIVITY TO PROVIDE UNIFORM & COMFORTABLE LIGHT LAYOUT
- STANDARD: CE, ROHS
- MSDS AVAILBLE

APPLICATIONS

OFFICE, SCHOOL, FACTORY, HOSPITAL...

SPECIFICATIONS

INPUT VOLTAGE: AC 90-265V 50/60HZ
CCT: 6000K-6500K
POWER: 3W
BATTERY: LI-ION 3.7V 2600MAH
MATERIAL: COLD-ROLLED STEEL + ACRYLIC
CHARGING TIME: ≥24 HOURS
EMERGENCY TIME: ≥3 HOURS
COLOR RENDERING INDEX: ≥80
IP GRADE: IP40
FACE: SINGLE/DOUBLE SIDES
LIGHTING SYSTEM: MAINTAINED
INSTALLING TYPE: RECESSED MOUNTED

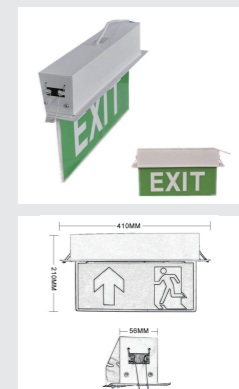

MODEL: EES-10B

FEATURES

- LIGHT BODY MADE FROM COLD-ROLLED STEEL AND 10MM ACRYLIC
- LI-ION BATTERY
- LED SUPER BRIGHT
- HIGH LUMINOUS EFFICENCY, LOWER THERMAL
- DIFFUSIVITY TO PROVIDE UNIFORM & COMFORTABLE LIGHT LAYOUT
- STANDARD: CE, ROHS
- MSDS AVAILBLE

APPLICATIONS

OFFICE, SCHOOL, FACTORY, HOSPITAL...

SPECIFICATIONS

INPUT VOLTAGE: AC 90-265V 50/60HZ
CCT: 6000K-6500K
POWER: 3W
BATTERY: LI-ION 3.7V 2200MAH
MATERIAL: COLD-ROLLED STEEL + 10MM ACRYLIC
CHARGING TIME: ≥12HOURS
EMERGENCY TIME: ≥2 HOURS
COLOR RENDERING INDEX: ≥80
IP GRADE: IP40
FACE: SINGLE/DOUBLE SIDES
LIGHTING SYSTEM: MAINTAINED
INSTALLING TYPE: RECESSED MOUNTED

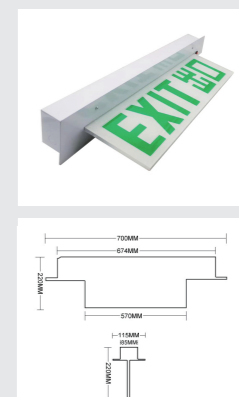

MODEL: EES-11

FEATURES

- LIGHT BODY MADE FROM IRON AND 10MM ACRYLIC
- LI-ION BATTERY
- LED SUPER BRIGHT
- HIGH LUMINOUS EFFICIENCY, LOWER THERMAL
- DIFFUSIVITY TO PROVIDE UNIFORM & COMFORTABLE LIGHT LAYOUT
- STANDARD: CE, ROHS
- MSDS AVAILBLE

APPLICATIONS

OFFICE, SCHOOL, FACTORY, HOSPITAL...

SPECIFICATIONS

INPUT VOLTAGE: AC 90-265V 50/60HZ
CCT: 6000K-6500K
POWER: 3W
BATTERY: LI-ION 3.7V 2200MAH
MATERIAL: IRON + 10MM ACRYLIC
CHARGING TIME: >12 HOURS
EMERGENCY TIME: >2 HOURS
COLOR RENDERING INDEX: >80
IP GRADE: IP40
FACE: SINGLE/DOUBLE SIDES
LIGHTING SYSTEM: MAINTAINED
INSTALLING TYPE: CEILING MOUNTED

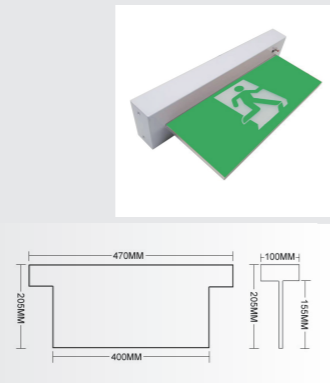

MODEL: ES-19

FEATURES

- LIGHT BODY MADE FROM PLASTIC AND ACRYLIC
- LI-ION BATTERY
- LED SUPER BRIGHT
- HIGH LUMINOUS EFFICIENCY, LOWER THERMAL
- DIFFUSIVITY TO PROVIDE UNIFORM & COMFORTABLE LIGHT LAYOUT
- STANDARD: CE, ROHS
- MSDS AVAILBLE

APPLICATIONS

OFFICE, SCHOOL, FACTORY, HOSPITAL...

SPECIFICATIONS

INPUT VOLTAGE: AC 85-265V 50/60HZ
LIGHT SOURCE: 14 PCS LED
POWER: 2W
BATTERY: LI-ION 3.7V 1200MAH
MATERIAL: PLASTIC AND ACRYLIC
CHARGING TIME: >24 HOURS
EMERGENCY TIME: 3 HOURS
COLOR: WHITE OR GREEN
PROTECTION: IP30
FACE: SINGLE/DOUBLE SIDES
TEMPERATURE RANG: 0°C ~ 55°C

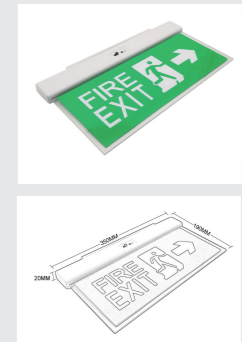

MODEL: EES-19

FEATURES

- LIGHT BODY MADE FROM ALUMINIUM AND ACRYLIC
- NI-CD BATTERY
- LED SUPER BRIGHT
- HIGH LUMINOUS EFFICIENCY, LOWER THERMAL
- DIFFUSIVITY TO PROVIDE UNIFORM & COMFORTABLE LIGHT LAYOUT
- STANDARD: CE, ROHS
- MSDS AVAILBLE

APPLICATIONS

OFFICE, SCHOOL, FACTORY, HOSPITAL...

SPECIFICATIONS

INPUT VOLTAGE: AC 85-265V 50/60HZ
LIGHT SOURCE: HIGH BRIGHT LED
BATTERY: NI-CD 3.6V 350MAH
MATERIAL: ALUMINIUM + ACRYLIC
CHARGING TIME: >24 HOURS
EMERGENCY TIME: >3 HOURS
THICKNESS OF ACRYLIC: 5MM
FACE: SINGLE/DOUBLE SIDES
LIGHTING SYSTEM: MAINTAINED
INSTALLING TYPE: RECESSED MOUNTED



MODEL: ES-20

FEATURES

- LIGHT BODY MADE FROM PLASTIC AND ACRYLIC
- LI-ION BATTERY
- LED SUPER BRIGHT
- HIGH LUMINOUS EFFICIENCY, LOWER THERMAL
- DIFFUSIVITY TO PROVIDE UNIFORM & COMFORTABLE LIGHT LAYOUT
- STANDARD: CE, ROHS
- MSDS AVAILBLE

APPLICATIONS

OFFICE, SCHOOL, FACTORY, HOSPITAL...

SPECIFICATIONS

INPUT VOLTAGE: AC 85-265V 50/60HZ
LIGHT SOURCE: 14 PCS LED
POWER: 2W
BATTERY: LI-ION 3.7V 1200MAH
MATERIAL: PLASTIC AND ACRYLIC
CHARGING TIME: >24 HOURS
EMERGENCY TIME: 3 HOURS
COLOR: WHITE OR BLACK
PROTECTION: IP30
FACE: SINGLE/DOUBLE SIDES
TEMPERATURE RANG: 0°C ~ 55°C

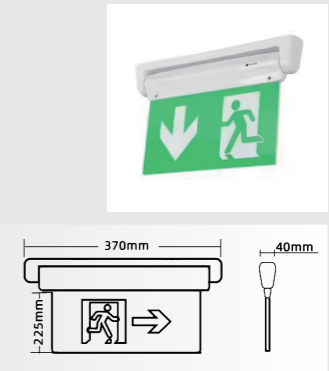

MODEL: ES-17/ES-18

FEATURES

- LIGHT BODY MADE FROM ALUMINIUM AND ACRYLIC
- NI-CD BATTERY
- LED SUPER BRIGHT
- HIGH LUMINOUS EFFICIENCY, LOWER THERMAL
- DIFFUSIVITY TO PROVIDE UNIFORM & COMFORTABLE LIGHT LAYOUT
- STANDARD: CE, ROHS
- MSDS AVAILBLE

APPLICATIONS

OFFICE, SCHOOL, FACTORY, HOSPITAL...

SPECIFICATIONS

INPUT VOLTAGE: AC 85-265V 50/60HZ
LIGHT SOURCE: 8 PCS LED
POWER: 2W/3W
BATTERY: NI-CD 3.6V 800MAH
MATERIAL: ALUMINIUM AND ACRYLIC
CHARGING TIME: >24 HOURS
EMERGENCY TIME: 3 HOURS
COLOR: WHITE OR GREEN
PROTECTION: IP30
FACE: SINGLE/DOUBLE SIDES
TEMPERATURE RANG: 0°C ~ 55°C

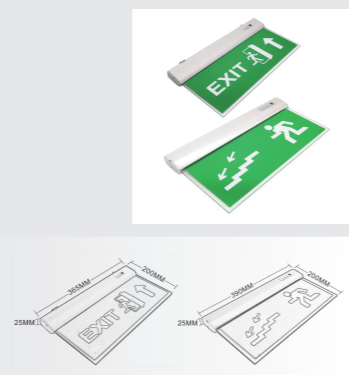

MODEL: ES-21

FEATURES

- LIGHT BODY MADE FROM POLYCARBONAT
- LI-ION BATTERY
- LED SUPER BRIGHT
- HIGH LUMINOUS EFFICIENCY, LOWER THERMAL
- DIFFUSIVITY TO PROVIDE UNIFORM & COMFORTABLE LIGHT LAYOUT
- STANDARD: CE, ROHS
- MSDS AVAILBLE

APPLICATIONS

OFFICE, SCHOOL, FACTORY, HOSPITAL...

SPECIFICATIONS

INPUT VOLTAGE: AC 95-265V 50/60HZ
LIGHT SOURCE: 2*12 PCS LED
POWER: 2W/3W
BATTERY: LI-ION 3.7V 1800MAH
MATERIAL: PLASTIC ABS
CHARGING TIME: >24 HOURS
EMERGENCY TIME: >3 HOURS
ILLUMINATION: GREEN AND RED OPTIONAL
HOUSING COLOR: WHITE AND BLACK OPTIONAL
IP RATE: IP30
INSTALLING TYPE: CEILING MOUNTED/
WALL MOUNTED

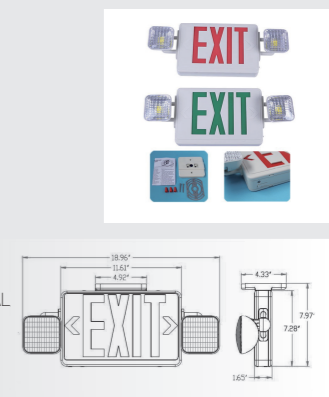

MODEL: EL-1803/EL-1803-T

FEATURES

- LIGHT BODY MADE FROM DIE-CAST ALUMINIUM
- NI-CD BATTERY
- LED SUPER BRIGHT
- HIGH LUMINOUS EFFICIENCY, LOWER THERMAL
- DIFFUSIVITY TO PROVIDE UNIFORM & COMFORTABLE LIGHT LAYOUT
- STANDARD: CE, ROHS
- MSDS AVAILBLE

APPLICATIONS

OFFICE, SCHOOL, FACTORY, HOSPITAL...

SPECIFICATIONS

INPUT VOLTAGE: AC220-240V 50/60HZ
EXPLOSION PROOF EXIT LIGHT
POWER: 2W/2*2W
LUMENS:120LM/240LM
BATTERY: 6V 800MAH NI-CD/6V 1200MAH NI-CD
MATERIAL: DIE-CAST ALUMINIUM
+TEMPERED GLASS
CHARGING TIME: >24 HOURS
EMERGENCY TIME: >2 HOURS
IP RATE: IP65

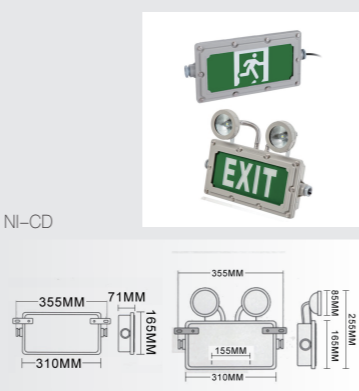

MODEL: ES-21A

FEATURES

- LIGHT BODY MADE FROM POLYCARBONAT
- NI-CD BATTERY
- LED SUPER BRIGHT
- HIGH LUMINOUS EFFICIENCY, LOWER THERMAL
- DIFFUSIVITY TO PROVIDE UNIFORM & COMFORTABLE LIGHT LAYOUT
- STANDARD: CE, ROHS
- MSDS AVAILBLE

APPLICATIONS

OFFICE, SCHOOL, FACTORY, HOSPITAL...

SPECIFICATIONS

INPUT VOLTAGE: AC 95-265V 50/60HZ
POWER: 2W/3W
BATTERY: NI- CD 3.6V 800MAH
MATERIAL: PLASTIC ABS
CHARGING TIME: >24 HOURS
EMERGENCY TIME: >3 HOURS
COLOR: GREEN OR RED
IP RATE: IP30
INSTALLING TYPE: CEILING MOUNTED/
WALL MOUNTED

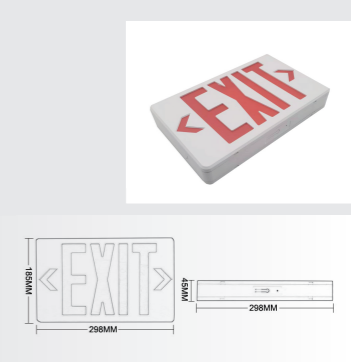

安全出口指示灯 Exit Lights

MODEL: ES-22

FEATURES

- LIGHT BODY MADE FROM POLYCARBONAT
- LI-ION BATTERY
- LED SUPER BRIGHT
- HIGH LUMINOUS EFFICENCY, LOWER THERMAL
- DIFFUSIVITY TO PROVIDE UNIFORM & COMFORTABLE LIGHT LAYOUT
- STANDARD: CE, ROHS
- MSDS AVAILBE

APPLICATIONS

OFFICE, SCHOOL, FACTORY, HOSPITAL...

SPECIFICATIONS

INPUT VOLTAGE: AC 95-265V 50/60HZ
 POWER: 2*2W+2W
 BATTERY: LI-ION 3.7V 1800MAH
 MATERIAL: PLASTIC ABS
 CHARGING TIME: ≥24 HOURS
 EMERGENCY TIME: ≥3 HOURS
 LED LIFETIME: ≥50000HOURS
 COLOR TEMP: WHITE
 PRODUCT SIZE: 330*85*322.5MM
 INSTALLING TYPE: WALL MOUNTED/SIDE MOUNTED



MODEL: ES-001

FEATURES

- LIGHT BODY MADE FROM ALUMINUM AND GLASS
- NI-CD BATTERY
- LED SUPER BRIGHT
- HIGH LUMINOUS EFFICENCY, LOWER THERMAL
- DIFFUSIVITY TO PROVIDE UNIFORM & COMFORTABLE LIGHT LAYOUT
- STANDARD: CE, ROHS
- MSDS AVAILBE

APPLICATIONS

OFFICE, SCHOOL, FACTORY, HOSPITAL...

SPECIFICATIONS

INPUT VOLTAGE: AC 85-265V 50/60HZ
 LIGHT SOURCE: 6 PCS LED
 SWITCH TIME: 0.1S
 BULB POWER: 1.6W
 BATTERY: NI-CD 1.2V 800MAH
 MATERIAL: ALUMINUM AND GLASS
 CHARGING TIME: ≥24 HOURS
 EMERGENCY TIME: 3 HOURS
 ILLUMINATION: GREEN,RED
 SIGHT DISTANCE: 20M
 FACE: SINGLE/DOUBLE SIDES
 IP GRADE: IP20
 INSTALLATION: WALL MOUNTED/CEILING MOUNTED



MODEL: ES-24

FEATURES

- LIGHT BODY MADE FROM POLYCARBONAT
- LI-ION BATTERY
- LED SUPER BRIGHT
- HIGH LUMINOUS EFFICENCY, LOWER THERMAL
- DIFFUSIVITY TO PROVIDE UNIFORM & COMFORTABLE LIGHT LAYOUT
- STANDARD: CE, ROHS
- MSDS AVAILBE

APPLICATIONS

OFFICE, SCHOOL, FACTORY, HOSPITAL...

SPECIFICATIONS

INPUT VOLTAGE: AC 85-265V 50/60HZ
 LIGHT SOURCE: 27 PCS SMD LED
 BATTERY: LI-ION 3.7V 1800MAH
 MATERIAL: PLASTIC ABS
 CHARGING TIME: ≥24 HOURS
 EMERGENCY TIME: ≥3 HOURS
 COLOR TEMP: 6000K
 TEST: M7 PUSH ON BUTTON
 LIGHTING SYSTEM: MAINTAINED/NON-MAINTAINED
 INSTALLING TYPE: CEILING MOUNTED

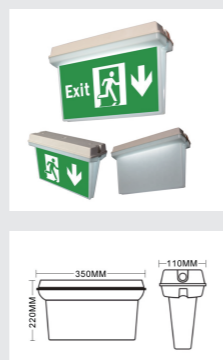

MODEL: ES-002

FEATURES

- LIGHT BODY MADE FROM IRON+PLASTIC+GLASS
- NI-CD BATTERY
- LED SUPER BRIGHT
- HIGH LUMINOUS EFFICENCY, LOWER THERMAL
- DIFFUSIVITY TO PROVIDE UNIFORM & COMFORTABLE LIGHT LAYOUT
- STANDARD: CE, ROHS
- MSDS AVAILBE

APPLICATIONS

OFFICE, SCHOOL, FACTORY, HOSPITAL...

SPECIFICATIONS

INPUT VOLTAGE: AC 220V 50/60HZ
 BULB POWER: 2W
 BATTERY: NI-CD 1.2V 800MAH
 MATERIAL: IRON+PLASTIC+GLASS
 CHARGING TIME: ≥24 HOURS
 EMERGENCY TIME: 3 HOURS
 INSTALLATION: WALL MOUNTED/CEILING MOUNTED
 PRODUCT SIZE: 358*157*24MM

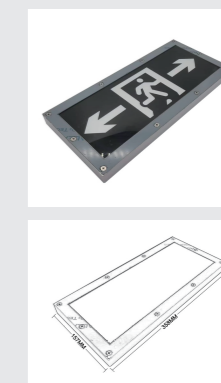

MODEL: ES-25

FEATURES

- LIGHT BODY MADE FROM PC AND ACRYLIC
- LIFEPO4 BATTERY
- LED SUPER BRIGHT
- HIGH LUMINOUS EFFICENCY, LOWER THERMAL
- DIFFUSIVITY TO PROVIDE UNIFORM & COMFORTABLE LIGHT LAYOUT
- STANDARD: CE, ROHS
- MSDS AVAILBE

APPLICATIONS

OFFICE, SCHOOL, FACTORY, HOSPITAL...

SPECIFICATIONS

INPUT VOLTAGE: AC 85-265V 50/60HZ
 POWER: 3W
 BATTERY: LIFEPO4 3.2V 1800MAH
 MATERIAL: PC+ACRYLIC
 CHARGING TIME: ≥24 HOURS
 EMERGENCY TIME: ≥3 HOURS
 CRI: RA80
 IP RATE: IP20
 PRODUCT SIZE: 365*240*95MM
 INSTALLING TYPE: CEILING MOUNTED

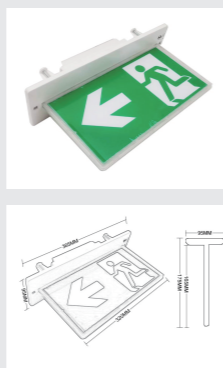

MODEL: ES-003

FEATURES

- LIGHT BODY MADE FROM PLASTIC+ACRYLIC
- NI-CD BATTERY
- LED SUPER BRIGHT
- HIGH LUMINOUS EFFICENCY, LOWER THERMAL
- DIFFUSIVITY TO PROVIDE UNIFORM & COMFORTABLE LIGHT LAYOUT
- STANDARD: CE, ROHS
- MSDS AVAILBE

APPLICATIONS

OFFICE, SCHOOL, FACTORY, HOSPITAL...

SPECIFICATIONS

INPUT VOLTAGE: AC 220V 50/60HZ
 BULB POWER: 2W
 BATTERY: NI-CD 1.2V 800MAH
 MATERIAL: PLASTIC+ACRYLIC
 CHARGING TIME: ≥24 HOURS
 EMERGENCY TIME: 3 HOURS
 INSTALLATION: WALL MOUNTED/CEILING MOUNTED
 PRODUCT SIZE: 360*160*24MM

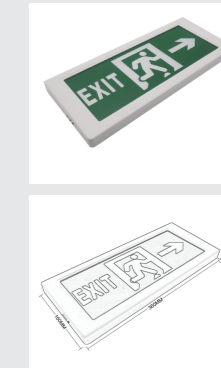

MODEL: XR-19

FEATURES

- LIGHT BODY MADE FROM ABS AND ACRYLIC
- LI-ION BATTERY
- LED SUPER BRIGHT
- HIGH LUMINOUS EFFICENCY, LOWER THERMAL
- DIFFUSIVITY TO PROVIDE UNIFORM & COMFORTABLE LIGHT LAYOUT
- STANDARD: CE, ROHS
- MSDS AVAILBE

APPLICATIONS

OFFICE, SCHOOL, FACTORY, HOSPITAL...

SPECIFICATIONS

INPUT VOLTAGE: AC 110-277V 50/60HZ
 LIGHT SOURCE: 12 PCS LED
 SWITCH TIME: 0.1S
 BULB POWER: 3W
 BATTERY: LI-ION 3.7V 1500MAH
 MATERIAL: ABS + ACRYLIC
 CHARGING TIME: ≥24 HOURS
 EMERGENCY TIME: 3 HOURS
 ILLUMINATION: GREEN,RED
 IP GRADE: IP44
 FACE: SINGLE/DOUBLE SIDES
 INSTALLATION: WALL MOUNTED/CEILING MOUNTED



MODEL: ES-004

FEATURES

- LIGHT BODY MADE FROM PLASTIC+ACRYLIC
- LI-ION BATTERY
- LED SUPER BRIGHT
- HIGH LUMINOUS EFFICENCY, LOWER THERMAL
- DIFFUSIVITY TO PROVIDE UNIFORM & COMFORTABLE LIGHT LAYOUT
- STANDARD: CE, ROHS
- MSDS AVAILBE

APPLICATIONS

OFFICE, SCHOOL, FACTORY, HOSPITAL...

SPECIFICATIONS

INPUT VOLTAGE: AC85-265V 50/60HZ
 BULB POWER: 2W
 BATTERY: LI-ION 3.7V 1500MAH
 MATERIAL: PLASTIC+ACRYLIC
 CHARGING TIME: ≥24 HOURS
 EMERGENCY TIME: 3 HOURS
 INSTALLATION: WALL MOUNTED/CEILING MOUNTED
 PRODUCT SIZE: 293*100MM*55MM



MODEL: EMO1W/EMOL1W

FEATURES

- LIGHT BODY MADE FROM IRON WITH EPOXY POWER COATING
- NI-CD/NI-MH BATTERY
- LED SUPER BRIGHT
- HIGH LUMINOUS EFFICIENCY, LOWER THERMAL
- DIFFUSIVITY TO PROVIDE UNIFORM & COMFORTABLE LIGHT LAYOUT
- STANDARD: CE, ROHS
- MSDS AVAILABLE

APPLICATIONS

OFFICE, SCHOOL, FACTORY, HOSPITAL...

SPECIFICATIONS

INPUT VOLTAGE: AC220-240V 50/60HZ
 POWER: 1W HIGH POWER LED
 MODE OF OPERATION: NON-MAINTAINED
 BATTERY: HT NI-CAD OR NI-MH
 LED INDICATOR: GREEN LED 5MM
 TEST FACILITY: MICRO SWITCH
 MATERIAL: IRON WITH EPOXY POWER COATING
 CHARGING TIME: ≥24 HOURS
 EMERGENCY TIME: ≥1.5 HOURS

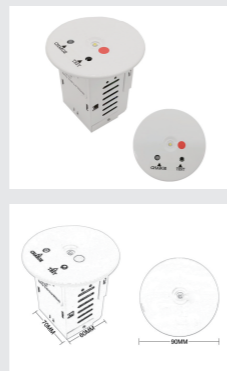

MODEL: UFO-30

FEATURES

- LIGHT BODY MADE FROM POLYCARBONAT
- LI-ION BATTERY
- LED SUPER BRIGHT
- HIGH LUMINOUS EFFICIENCY, LOWER THERMAL
- DIFFUSIVITY TO PROVIDE UNIFORM & COMFORTABLE LIGHT LAYOUT
- STANDARD: CE, ROHS
- MSDS AVAILABLE

APPLICATIONS

OFFICE, SCHOOL, FACTORY, HOSPITAL...

SPECIFICATIONS

INPUT VOLTAGE: AC220-240V 50/60HZ
 POWER: 2W LED SOURCE
 CCT: 6000K
 BATTERY: 3.7V 1800MAH LITHIUM
 LUMEN: 150LM
 IP RATING: IP55 (SURFACE), IP40 (BLACK BODY)
 MATERIAL: FIRE RETARDANT ABS + PC
 CHARGING TIME: ≥24 HOURS
 EMERGENCY TIME: ≥3 HOURS
 TA: -10°C ~ 45°C
 TC: 80°C

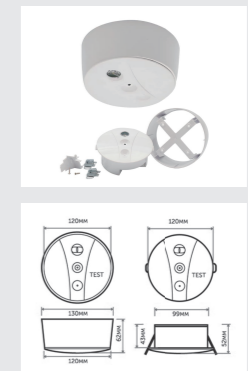

MODEL: EMO101

FEATURES

- LIGHT BODY MADE FROM PLASTIC
- LI-ION BATTERY
- LED SUPER BRIGHT
- HIGH LUMINOUS EFFICIENCY, LOWER THERMAL
- DIFFUSIVITY TO PROVIDE UNIFORM & COMFORTABLE LIGHT LAYOUT
- STANDARD: CE, ROHS
- MSDS AVAILABLE

APPLICATIONS

OFFICE, SCHOOL, FACTORY, HOSPITAL...

SPECIFICATIONS

INPUT VOLTAGE: AC220-240V 50/60HZ
 POWER: 3W
 CCT: 6000K
 BATTERY: LI-ION 3.7V
 IP RATING: IP20
 WORKING TEMP: 0°C ~ 50°C
 MATERIAL: PLASTIC
 CHARGING TIME: ≥24 HOURS
 EMERGENCY TIME: ≥3 HOURS
 SWITCHING TIME TO EMERGENCY: 2S



MODEL: UFO919

FEATURES

- LIGHT BODY MADE FROM POLYCARBONAT
- NI-CD BATTERY
- LED SUPER BRIGHT
- HIGH LUMINOUS EFFICIENCY, LOWER THERMAL
- DIFFUSIVITY TO PROVIDE UNIFORM & COMFORTABLE LIGHT LAYOUT
- STANDARD: CE, ROHS
- MSDS AVAILABLE

APPLICATIONS

OFFICE, SCHOOL, FACTORY, HOSPITAL...

SPECIFICATIONS

INPUT VOLTAGE: AC220-240V 50/60HZ
 POWER: 3W
 MODE OF OPERATION: NON-MAINTAINED/MAINTAINED
 BATTERY: NI-CD 2.4V 2000MAH
 CCT: 6000K
 LUMEN: 250LM
 IP RATING: IP20
 PRODUCT SIZE: D95*H90MM
 CUT OUT: 82MM
 CHARGING TIME: ≥24 HOURS
 EMERGENCY TIME: ≥3 HOURS



MODEL: EMO102

FEATURES

- LIGHT BODY MADE FROM PLASTIC
- LI-ION BATTERY
- LED SUPER BRIGHT
- HIGH LUMINOUS EFFICIENCY, LOWER THERMAL
- DIFFUSIVITY TO PROVIDE UNIFORM & COMFORTABLE LIGHT LAYOUT
- STANDARD: CE, ROHS
- MSDS AVAILABLE

APPLICATIONS

OFFICE, SCHOOL, FACTORY, HOSPITAL...

SPECIFICATIONS

INPUT VOLTAGE: AC220-240V 50/60HZ
 POWER: 3W
 LED: SMD 3535 6V 3W LED 6500K
 BATTERY: LI-ION 3.7V 1800MAH
 IP RATING: IP20
 WORKING TEMP: 0°C ~ 50°C
 MATERIAL: PLASTIC
 CHARGING TIME: ≥24 HOURS
 EMERGENCY TIME: ≥1.5 HOURS
 INSTALLING TYPE: RECESSED MOUNTED



MODEL: UFO3W

FEATURES

- LIGHT BODY MADE FROM IRON
- NI-CD BATTERY
- LED SUPER BRIGHT
- HIGH LUMINOUS EFFICIENCY, LOWER THERMAL
- DIFFUSIVITY TO PROVIDE UNIFORM & COMFORTABLE LIGHT LAYOUT
- STANDARD: CE, ROHS
- MSDS AVAILABLE

APPLICATIONS

OFFICE, SCHOOL, FACTORY, HOSPITAL...

SPECIFICATIONS

INPUT VOLTAGE: AC220-240V 50/60HZ
 POWER: 3W
 CCT: 6500K
 BATTERY: 3.6V 1500MAH NI-CD
 LUMINAIR: LED 3.2V 0.5A 1.6W, MAX 3W
 LUMEN OUTPUT: 150LM, MAX 200LM
 MATERIAL: IRON
 CHARGING TIME: ≥24 HOURS
 EMERGENCY TIME: ≥3 HOURS
 TA: -10°C ~ 40°C
 TC: 80°C



应急灯 Emergency light

MODEL: 3331/3361/3391/33121

FEATURES

- LIGHT BODY MADE FROM POLYCARBONAT
- NI-CD BATTERY
- LED SUPER BRIGHT
- HIGH LUMINOUS EFFICENCY, LOWER THERMAL
- DIFFUSIVITY TO PROVIDE UNIFORM & COMFORTABLE LIGHT LAYOUT
- STANDARD: CE, ROHS
- MSDS AVAILBLE

APPLICATIONS

OFFICE, SCHOOL, FACTORY, HOSPITAL...

SPECIFICATIONS

LIGHT SOURCE: 30/60/90/120LEDS
 POWER: 2.1/4.2/6.3/8.4W
 CCT: 6500K
 RECHARGING VOLTAGE RATE: AC 220-240V
 BATTERYVOLTAGE RATE: DC 4V
 BATTERY CAPACITY: 1100MAH
 BODY MATERIAL: PLASTIC
 MODE: LOW & HIGH
 EMERGENCY TIME: 3 HOURS
 STANDARD NO: Q/STLM 0016-2011



MODEL: 40812/40824/40848

FEATURES

- LIGHT BODY MADE FROM IRON
- NI-CD BATTERY
- LED SUPER BRIGHT
- HIGH LUMINOUS EFFICENCY, LOWER THERMAL
- DIFFUSIVITY TO PROVIDE UNIFORM & COMFORTABLE LIGHT LAYOUT
- STANDARD: CE, ROHS
- MSDS AVAILBLE

APPLICATIONS

OFFICE, SCHOOL, FACTORY, HOSPITAL...

SPECIFICATIONS

LIGHT SOURCE: 16/28/58PCS 2835
 POWER: 20/40/60W
 CCT: 3000K-6500K
 POWER SUPPLY MODE: 5V USB CHARGING
 PROTECTION LEVEL: IP65
 LIFE: 2000(H)
 BODY MATERIAL: PLASTIC
 MODE: FULL BRIGHTNESS MODE/
 MEDIUM BRIGHTNESS MODE/
 FLASHING MODE
 EMERGENCY TIME: 3-5 HOURS

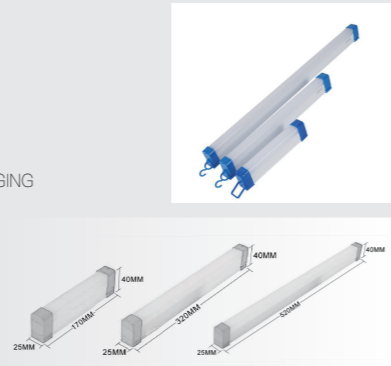

MODEL: EMT20

FEATURES

- WATERPROOF LIGHT BODY MADE FROM
- POLYCARBONAT
- LI-ION BATTERY
- LED SUPER BRIGHT
- HIGH LUMINOUS EFFICENCY, LOWER THERMAL
- DIFFUSIVITY TO PROVIDE UNIFORM & COMFORTABLE LIGHT LAYOUT
- STANDARD: CE, ROHS
- MSDS AVAILBLE

APPLICATIONS

OFFICE, SCHOOL, FACTORY, HOSPITAL...

SPECIFICATIONS

LIGHT SOURCE: 30LEDS
 POWER: 20W
 EMERGENCY POWER: 5W
 INPUT VOLTAGE: AC 220-240V 50/60HZ
 BATTERY: LI-ION 7.4V 2500MAH
 BODY MATERIAL: PLASTIC
 CHARGING TIME: ≥24 HOURS
 EMERGENCY TIME: ≥3 HOURS
 CRI: ≥80
 IP RATING: IP65

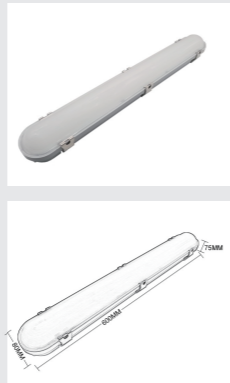

MODEL: EMT36

FEATURES

- WATERPROOF LIGHT BODY MADE
- FROM POLYCARBONAT
- LI-ION BATTERY
- LED SUPER BRIGHT
- HIGH LUMINOUS EFFICENCY, LOWER THERMAL
- DIFFUSIVITY TO PROVIDE UNIFORM & COMFORTABLE LIGHT LAYOUT
- STANDARD: CE, ROHS
- MSDS AVAILBLE

APPLICATIONS

OFFICE, SCHOOL, FACTORY, HOSPITAL...

SPECIFICATIONS

LIGHT SOURCE: 2835 SMD
 POWER: 36W
 EMERGENCY POWER: 5W
 INPUT VOLTAGE: AC 220-240V 50/60HZ
 BATTERY: LI-ION 7.4V 2500MAH
 BODY MATERIAL: PLASTIC
 CHARGING TIME: ≥24 HOURS
 EMERGENCY TIME: ≥3 HOURS
 CRI: ≥80
 IP RATING: IP65



双头应急灯 Twin Head Emergency Light

EMERGENCY LIGHT

MODEL: EH-06

FEATURES

- LIGHT BODY MADE FROM POLYCARBONAT
- NI-CD/LI-ION/LEAD ACID BATTERY
- LED SUPER BRIGHT
- HIGH LUMINOUS EFFICENCY, LOWER THERMAL
- DIFFUSIVITY TO PROVIDE UNIFORM & COMFORTABLE LIGHT LAYOUT
- STANDARD: CE, ROHS
- MSDS AVAILBLE

APPLICATIONS

OFFICE, SCHOOL, FACTORY, HOSPITAL...

SPECIFICATIONS

INPUT VOLTAGE: AC85-265V 50/60HZ
 POWER: 2*2W/2*3W
 BATTERY: NI-CD 3.6V 1500MAH
 LI-ION 3.7V 1800MAH / LEAD ACID 4V/6V
 CCT: 6000K
 WORKING TEMP: 0°C ~ 55°C
 MATERIAL: ABS PLASTIC
 PRODUCT SIZE: 310*140*92MM
 CHARGING TIME: ≥24 HOURS
 EMERGENCY TIME: ≥3 HOURS



MODEL: EH-07

FEATURES

- LIGHT BODY MADE FROM POLYCARBONAT
- LI-ION BATTERY
- LED SUPER BRIGHT
- HIGH LUMINOUS EFFICENCY, LOWER THERMAL
- DIFFUSIVITY TO PROVIDE UNIFORM & COMFORTABLE LIGHT LAYOUT
- STANDARD: CE, ROHS
- MSDS AVAILBLE

APPLICATIONS

OFFICE, SCHOOL, FACTORY, HOSPITAL...

SPECIFICATIONS

INPUT VOLTAGE: AC85-265V 50/60HZ
 POWER: 2*3W
 BATTERY: LI-ION 3.7V 1800MAH
 CCT: 6000K
 MATERIAL: ABS PLASTIC
 PRODUCT SIZE: 260*120*90MM
 CHARGING TIME: ≥24 HOURS
 EMERGENCY TIME: ≥3 HOURS



MODEL: EH-08

FEATURES

- LIGHT BODY MADE FROM POLYCARBONAT
- NI-CD/LI-ION BATTERY
- LED SUPER BRIGHT
- HIGH LUMINOUS EFFICENCY, LOWER THERMAL
- DIFFUSIVITY TO PROVIDE UNIFORM & COMFORTABLE LIGHT LAYOUT
- STANDARD: CE, ROHS
- MSDS AVAILBLE

APPLICATIONS

OFFICE, SCHOOL, FACTORY, HOSPITAL...

SPECIFICATIONS

INPUT VOLTAGE: AC85-265V 50/60HZ
 POWER: 2*2W/2*3W
 BATTERY: NI-CD 3.6V 1500MAH
 LI-ION 3.7V 1800MAH
 CCT: 6000K
 WORKING TEMP: 0°C ~ 55°C
 MATERIAL: ABS PLASTIC
 PRODUCT SIZE: 260*100*55MM
 CHARGING TIME: ≥24 HOURS
 EMERGENCY TIME: ≥3 HOURS



MODEL: EMB268

FEATURES

- LIGHT BODY MADE FROM POLYCARBONAT
- LI-ION BATTERY
- LED SUPER BRIGHT
- HIGH LUMINOUS EFFICENCY, LOWER THERMAL
- DIFFUSIVITY TO PROVIDE UNIFORM & COMFORTABLE LIGHT LAYOUT
- STANDARD: CE, ROHS
- MSDS AVAILBLE

APPLICATIONS

OFFICE, SCHOOL, FACTORY, HOSPITAL...

SPECIFICATIONS

INPUT VOLTAGE: AC85-265V 50/60HZ
 POWER: 2*2W/2*3W
 BATTERY: NI-CD 3.6V 1500MAH
 LI-ION 3.7V 1800MAH LEAD ACID 4V 5A
 CCT: 6000K
 WORKING TEMP: 0°C ~ 55°C
 MATERIAL: ABS PLASTIC
 PRODUCT SIZE: 400*170*77MM
 CHARGING TIME: ≥24 HOURS
 EMERGENCY TIME: ≥3 HOURS



双头应急灯 Twin Head Emergency Light

MODEL: EMT-02

FEATURES

- LIGHT BODY MADE FROM POLYCARBONAT
- NI-CD/LI-ION BATTERY
- LED SUPER BRIGHT
- HIGH LUMINOUS EFFICENCY, LOWER THERMAL
- DIFFUSIVITY TO PROVIDE UNIFORM & COMFORTABLE LIGHT LAYOUT
- STANDARD: CE, ROHS
- MSDS AVAILBLE

APPLICATIONS

OFFICE, SCHOOL, FACTORY, HOSPITAL...

SPECIFICATIONS

INPUT VOLTAGE: AC85-265V 50/60HZ
 POWER: 2*2W/2*3W
 BATTERY: NI-CD 3.6V 1500MAH LI-ION 3.7V 1800MAH
 CCT: 6000K
 WORKING TEMP: 0°C ~ 55°C
 MATERIAL: ABS PLASTIC
 PRODUCT SIZE: 300*140*90MM
 CHARGING TIME: ≥24 HOURS
 EMERGENCY TIME: ≥3 HOURS



MODEL: EMT-09

FEATURES

- LIGHT BODY MADE FROM PC
- BODY COLOR: WHITE/BLACK/YELLOW OPTIONAL
- NI-CD BATTERY
- LED SUPER BRIGHT
- HIGH LUMINOUS EFFICENCY, LOWER THERMAL
- DIFFUSIVITY TO PROVIDE UNIFORM & COMFORTABLE LIGHT LAYOUT
- STANDARD: CE, ROHS
- MSDS AVAILBLE

APPLICATIONS

OFFICE, SCHOOL, FACTORY, HOSPITAL...

SPECIFICATIONS

INPUT VOLTAGE: AC85-265V 50/60HZ
 POWER: 2*5W OR 2*10W
 BATTERY: 6V NI-CD OR LEAD ACID
 CCT: 6000K
 WORKING TEMP: 0°C ~ 55°C
 WATERPROOF: IP65
 PRODUCT SIZE: 255*65*315MM
 CHARGING TIME: ≥24 HOURS
 EMERGENCY TIME: ≥3 HOURS

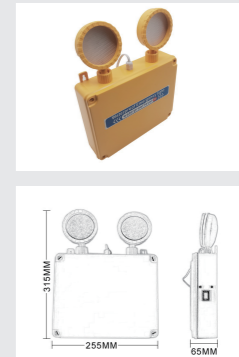

MODEL: EMT-06

FEATURES

- LIGHT BODY MADE FROM POLYCARBONAT
- LI-ION/LEAD ACID BATTERY
- LED SUPER BRIGHT
- HIGH LUMINOUS EFFICENCY, LOWER THERMAL
- DIFFUSIVITY TO PROVIDE UNIFORM & COMFORTABLE LIGHT LAYOUT
- STANDARD: CE, ROHS
- MSDS AVAILBLE

APPLICATIONS

OFFICE, SCHOOL, FACTORY, HOSPITAL...

SPECIFICATIONS

INPUT VOLTAGE: AC85-265V 50/60HZ
 POWER: 2*2W/2*3W
 BATTERY: LI-ION 3.7V 1800MAH OR LEAD ACID 4V 5A
 CCT: 6000K
 WORKING TEMP: 0°C ~ 55°C
 MATERIAL: ABS
 PRODUCT SIZE: 275*70*280MM
 CHARGING TIME: ≥24 HOURS
 EMERGENCY TIME: ≥3 HOURS



MODEL: EMT-H4

FEATURES

- LIGHT BODY MADE FROM IRON AND PC
- NI-CD/LEAD ACID BATTERY
- LED SUPER BRIGHT
- HIGH LUMINOUS EFFICENCY, LOWER THERMAL
- DIFFUSIVITY TO PROVIDE UNIFORM & COMFORTABLE LIGHT LAYOUT
- STANDARD: CE, ROHS
- MSDS AVAILBLE

APPLICATIONS

OFFICE, SCHOOL, FACTORY, HOSPITAL...

SPECIFICATIONS

INPUT VOLTAGE: AC85-265V 50/60HZ
 POWER: 2*2W
 BATTERY: NI-CD 3.6V OR LEAD ACID 4V/6V
 CCT: 6000K
 WORKING TEMP: 0°C ~ 55°C
 MATERIAL: IRON + PC
 PRODUCT SIZE: 270*82*295MM
 CHARGING TIME: ≥24 HOURS
 EMERGENCY TIME: ≥3 HOURS
 FUCTION: WITH FUSE AND TEST BUTTON

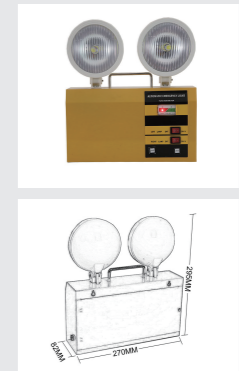

MODEL: EMT-07

FEATURES

- LIGHT BODY MADE FROM IRON AND PC
- LI-ION BATTERY
- LED SUPER BRIGHT
- HIGH LUMINOUS EFFICENCY, LOWER THERMAL
- DIFFUSIVITY TO PROVIDE UNIFORM & COMFORTABLE LIGHT LAYOUT
- STANDARD: CE, ROHS
- MSDS AVAILBLE

APPLICATIONS

OFFICE, SCHOOL, FACTORY, HOSPITAL...

SPECIFICATIONS

INPUT VOLTAGE: AC85-265V 50/60HZ
 POWER: 2*3W
 BATTERY: LI-ION 3.7V 1800MAH
 BULB: 2835 LED
 WORKING TEMP: -10°C ~ 55°C
 MATERIAL: IRON + PC
 PRODUCT SIZE: 262*64*270MM
 CHARGING TIME: ≥24 HOURS
 EMERGENCY TIME: ≥3 HOURS

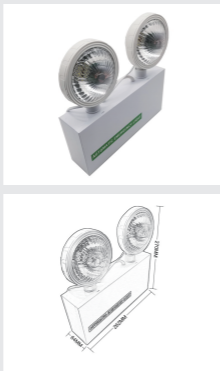

MODEL: EMT-S1018

FEATURES

- LIGHT BODY MADE FROM IRON AND PC
- NI-CD/LEAD ACID BATTERY
- LED SUPER BRIGHT
- HIGH LUMINOUS EFFICENCY, LOWER THERMAL
- DIFFUSIVITY TO PROVIDE UNIFORM & COMFORTABLE LIGHT LAYOUT
- STANDARD: CE, ROHS
- MSDS AVAILBLE

APPLICATIONS

OFFICE, SCHOOL, FACTORY, HOSPITAL...

SPECIFICATIONS

INPUT VOLTAGE: AC85-265V 50/60HZ
 POWER: 2*2W
 BATTERY: NI-CD 3.6V OR LEAD ACID 4V/6V
 CCT: 6000K
 WORKING TEMP: 0°C ~ 55°C
 MATERIAL: IRON + PC
 PRODUCT SIZE: 270*82*295MM
 CHARGING TIME: ≥24 HOURS
 EMERGENCY TIME: ≥3 HOURS



MODEL: EMT-08

FEATURES

- LIGHT BODY MADE FROM POLYCARBONAT
- LI-ION BATTERY
- LED SUPER BRIGHT
- HIGH LUMINOUS EFFICENCY, LOWER THERMAL
- DIFFUSIVITY TO PROVIDE UNIFORM & COMFORTABLE LIGHT LAYOUT
- STANDARD: CE, ROHS
- MSDS AVAILBLE

APPLICATIONS

OFFICE, SCHOOL, FACTORY, HOSPITAL...

SPECIFICATIONS

INPUT VOLTAGE: AC85-265V 50/60HZ
 POWER: 2*3W+3W
 BATTERY: LI-ION 3.7V 1800MAH
 CCT: 6000K
 IP RATE: IP30
 PRODUCT SIZE: 305*55*340MM
 CHARGING TIME: ≥24 HOURS
 EMERGENCY TIME: ≥3 HOURS
 INSTALLATION: WALL MOUNTED



MODEL: EMT-10

FEATURES

- LIGHT BODY MADE FROM POLYCARBONAT
- NI-CD BATTERY
- LED SUPER BRIGHT
- HIGH LUMINOUS EFFICENCY, LOWER THERMAL
- DIFFUSIVITY TO PROVIDE UNIFORM & COMFORTABLE LIGHT LAYOUT
- STANDARD: CE, ROHS
- MSDS AVAILBLE

APPLICATIONS

OFFICE, SCHOOL, FACTORY, HOSPITAL...

SPECIFICATIONS

INPUT VOLTAGE: AC85-265V 50/60HZ
 POWER: 2*5W
 LIGHT SOURCE: 2*9PCS LED 5050 SMD
 BATTERY: NI-CD 3.6V 600MAH
 CCT: 6000K
 WORKING TEMP: 0°C ~ 55°C
 MATERIAL: ABS+PC
 PRODUCT SIZE: 280*75*290MM
 CHARGING TIME: ≥24 HOURS
 EMERGENCY TIME: ≥2 HOURS





EMERGENCY BATTERY PACKS SERIES



驱动应急一体化 Combo Emergency battery pack

MODEL: LEM2058A

FEATURES

- LED INDICATOR & TEST BUTTON EXTERNA WITH CABLE
- 7.4V LI-ION BATTERY (OTHER CUSTOMIZED)
- BODY MATERIAL METAL
- 3 HOURS RATED DURATION
- STANDARD: CE, ROHS
- 3 YEARS WARRANTY

APPLICATIONS

[ADJUSTABLE COMBO](#) (LED DRIVER INTEGRATED)
[3-25W LED](#) (LED BOARD, LED WITHOUT DRIVER, ETC...)

SPECIFICATIONS

EMERGENCY POWER: 3W-5W-8W CONSTANT POWER
 INPUT VOLTAGE: AC85-265V 50/60HZ
 NORMAL OUTPUT VOLTAGE: 24-72V(80V MAX)
 EMERGENCY OUTPUT VOLTAGE: DC10-175V
 BATTERY: 7.4V 2500MAH 18650 BUILT IN
 BODY MATERIAL: PLASTIC
 PRODUCT SIZE: 242*40*27MM

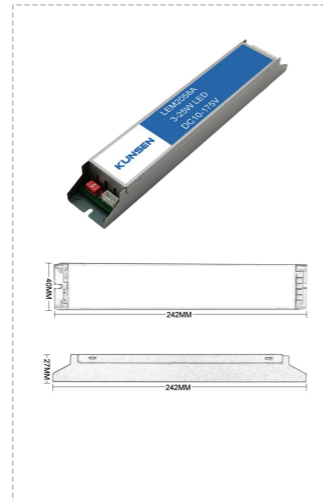

MODEL: LEM5058A

FEATURES

- LED INDICATOR & TEST BUTTON EXTERNA WITH CABLE
- 7.4V OR 11.1V LI-ION BATTERY (OTHER CUSTOMIZED)
- BODY MATERIAL METAL
- 3 HOURS RATED DURATION
- STANDARD: CE, ROHS
- 3 YEARS WARRANTY

APPLICATIONS

[ADJUSTABLE COMBO](#) (LED DRIVER INTEGRATED)
[8-50W LED](#) (LED BOARD, LED WITHOUT DRIVER, ETC...)

SPECIFICATIONS

EMERGENCY POWER: 3W-5W-8W CONSTANT POWER
 INPUT VOLTAGE: AC85-265V 50/60HZ
 NORMAL OUTPUT VOLTAGE: 24-72V(80V MAX)
 EMERGENCY OUTPUT VOLTAGE: DC10-175V
 BATTERY: 7.4V 2500MAH OR 11.1V 2500MAH 18650 EXTERNAL
 BODY MATERIAL: PLASTIC
 PRODUCT SIZE: 100*66*30MM

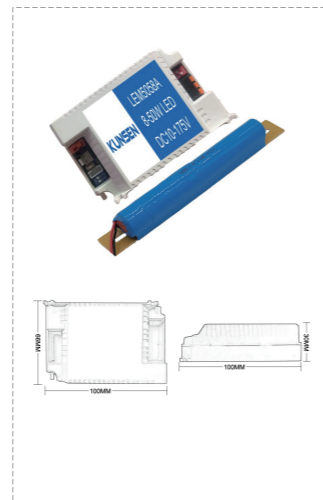

MODEL: LEM-J3WT

FEATURES

- 3.7V LI-ION BATTERY (OTHER CUSTOMIZED)
- BODY MATERIAL PLASTIC
- MORE THAN 1HOURS DURATION
- STANDARD: CE, ROHS
- 1 YEARS WARRANTY

APPLICATIONS

[3-24W LED LIGHT EMERGENCY DRIVER](#)
 (LED PANEL, LED DOWN LIGHT ETC...)

SPECIFICATIONS

EMERGENCY POWER: 3W
 INPUT VOLTAGE: AC85-265V 50/60HZ
 OUTPUT VOLTAGE: DC 3-12V
 BATTERY: 3.7V 800MAH 18650 EXTERNAL
 BODY MATERIAL: PLASTIC
 PRODUCT SIZE: 98*58*27MM



全功率应急电源 Full Emergency power battery pack

EMERGENCY BATTERY PACKS

MODEL: LEM-M50WT-2

FEATURES

- WATERPROOF LED INDICATOR & TEST BUTTON EXTERNAL WITH CABLE
- 14.8V LI-ION BATTERY (OTHER CUSTOMIZED)
- BODY MATERIAL ALUMINUM
- MORE THAN 1 HOURS DURATION
- STANDARD: CE, ROHS
- 3 YEARS WARRANTY

APPLICATIONS

[50W MAX LED](#)
 (LED TUBE, LED PANEL, LED DOWN LIGHT, LED TRI-PROOF LIGHT ETC...)

SPECIFICATIONS

EMERGENCY POWER: 50W MAX
 INPUT VOLTAGE: AC85-265V 50/60HZ
 OUTPUT VOLTAGE: DC 220V
 BATTERY: 14.8V LI-ION 18650 BUILT IN
 BODY MATERIAL: PLASTIC
 PRODUCT SIZE: 240*75*40MM

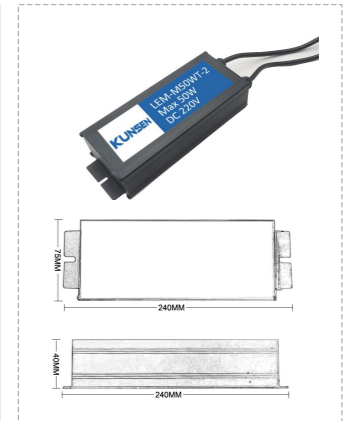

MODEL: LEM-M50WT

FEATURES

- LED INDICATOR & TEST BUTTON EXTERNAL WITH CABLE
- 11.1V LI-ION BATTERY (OTHER CUSTOMIZED)
- BODY MATERIAL PLASTIC
- MORE THAN 1 HOURS DURATION
- STANDARD: CE, ROHS
- 3 YEARS WARRANTY

APPLICATIONS

[50W MAX LED WITH 220V INPUT VOLTAGE](#)
 (LED TUBE, LED PANEL, LED DOWN LIGHT, LED TRI-PROOF LIGHT ETC...)

SPECIFICATIONS

EMERGENCY POWER: 50W MAX
 INPUT VOLTAGE: AC85-265V 50/60HZ
 OUTPUT VOLTAGE: DC 220V
 BATTERY: 11.1V 2500MAH 18650 EXTERNAL
 BODY MATERIAL: PLASTIC
 PRODUCT SIZE: 182*30*25MM

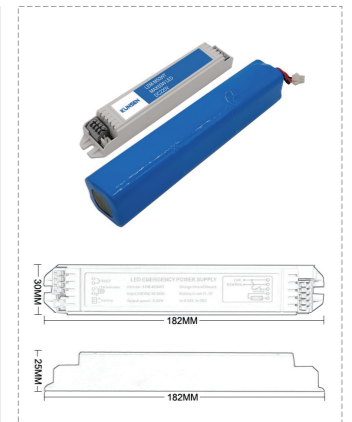

MODEL: LEM-M50WTJ

FEATURES

- LED INDICATOR & TEST BUTTON EXTERNAL WITH CABLE
- 11.1V LI-ION BATTERY (OTHER CUSTOMIZED)
- BODY MATERIAL IRON
- MORE THAN 1 HOURS DURATION
- STANDARD: CE, ROHS
- 3 YEARS WARRANTY

APPLICATIONS

[50W MAX LED WITH 220V INPUT VOLTAGE](#)
 (LED TUBE, LED PANEL, LED DOWN LIGHT, LED TRI-PROOF LIGHT ETC...)

SPECIFICATIONS

EMERGENCY POWER: 50W MAX
 INPUT VOLTAGE: AC85-265V 50/60HZ
 OUTPUT VOLTAGE: DC 220V
 BATTERY: 11.1V 2500MAH 18650 EXTERNAL
 BODY MATERIAL: IRON
 PRODUCT SIZE: 207*33*26MM

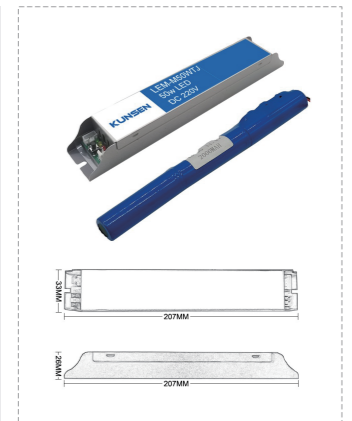

MODEL: LEM20T-AIO

FEATURES

- LED INDICATOR & TEST BUTTON EXTERNAL WITH CABLE
- 11.1V LI-ION BATTERY (OTHER CUSTOMIZED)
- BODY MATERIAL METAL
- MORE THAN 1 HOURS DURATION
- STANDARD: CE, ROHS
- 3 YEARS WARRANTY

APPLICATIONS

[20W MAX LED WITH 220V INPUT VOLTAGE](#)
 (LED PANEL, LED DOWN LIGHT, LED TUBE, LED LINER ETC...)

SPECIFICATIONS

EMERGENCY POWER: 20W MAX
 INPUT VOLTAGE: AC85-265V 50/60HZ
 OUTPUT VOLTAGE: DC220V
 BATTERY: 11.1 2500MAH 18650 BUILT IN
 BODY MATERIAL: METAL
 PRODUCT SIZE: 220*40*26MM

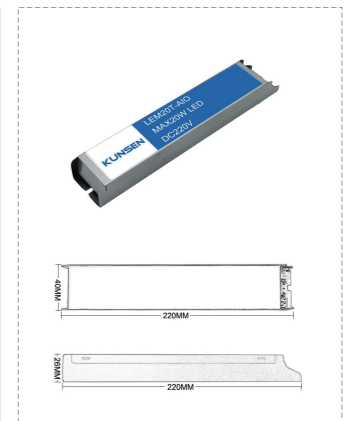

MODEL: LEM20T-P

FEATURES

- LED INDICATOR & TEST BUTTON EXTERNAL WITH CABLE
- 11.1V LI-ION BATTERY (OTHER CUSTOMIZED)
- BODY MATERIAL PLASTIC
- MORE THAN 1 HOURS DURATION
- STANDARD: CE, ROHS
- 3 YEARS WARRANTY

SPECIFICATIONS

EMERGENCY POWER: 20W MAX
 INPUT VOLTAGE: AC85-265V 50/60HZ
 OUTPUT VOLTAGE: DC220V
 BATTERY: 11.1 2500MAH 18650 EXTERNAL
 BODY MATERIAL: PLASTIC
 PRODUCT SIZE: 150*30*25MM
 BATTERY SIZE: 18*18*195MM OR 54*18*65MM

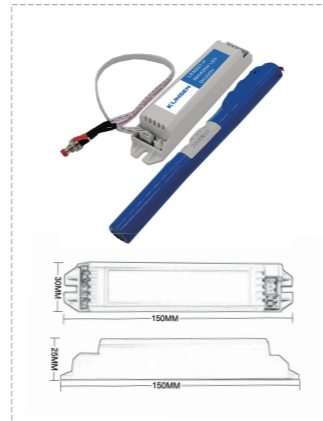

APPLICATIONS

20W MAX LED WITH 220V INPUT VOLTAGE
 (LED PANEL,LED DOWN LIGHT,LED TUBE,ETC...)

MODEL: LEM20T-S

FEATURES

- LED INDICATOR & TEST BUTTON EXTERNAL WITH CABLE
- 11.1V LI-ION BATTERY (OTHER CUSTOMIZED)
- BODY MATERIAL METAL
- MORE THAN 1 HOURS DURATION
- STANDARD: CE, ROHS
- 3 YEARS WARRANTY

SPECIFICATIONS

EMERGENCY POWER: 20W MAX
 INPUT VOLTAGE: AC85-265V 50/60HZ
 OUTPUT VOLTAGE: DC220V
 BATTERY: 11.1 2500MAH 18650 EXTERNAL
 BODY MATERIAL: METAL
 PRODUCT SIZE: 220*24*22MM

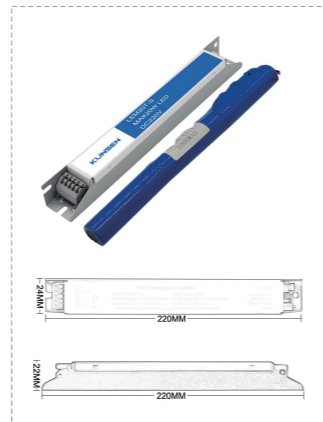

APPLICATIONS

20W MAX LED WITH 220V INPUT VOLTAGE
 (LED PANEL,LED DOWN LIGHT,LED TUBE,LED LINER ETC...)

MODEL: LEM20T-SR

FEATURES

- LED INDICATOR & TEST BUTTON EXTERNAL WITH CABLE
- 11.1V LI-ION BATTERY (OTHER CUSTOMIZED)
- BODY MATERIAL PLASTIC
- MORE THAN 1 HOURS DURATION
- STANDARD: CE, ROHS
- 3 YEARS WARRANTY

SPECIFICATIONS

EMERGENCY POWER: 20W MAX
 INPUT VOLTAGE: AC/DC 12-48V
 OUTPUT VOLTAGE: DC12V/24V/36V/48V ADJUSTABLE
 BATTERY: 11.1 2500MAH 18650 EXTERNAL
 BODY MATERIAL: PLASTIC
 PRODUCT SIZE: 148*40*28MM

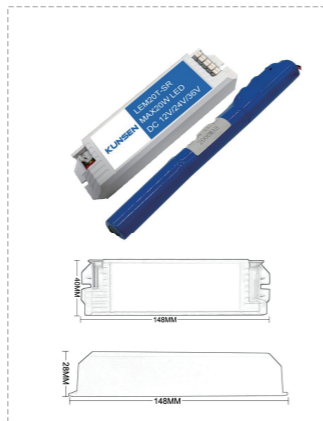

APPLICATIONS

FOR MAX 20W 12V-48V LOW VOLTAGE LED LAMP
 VOLTAGE LED LAMP (LED STRIP ETC...)

MODEL: LEM28T\LEM28TA

FEATURES

- LED INDICATOR & TEST BUTTON EXTERNAL WITH CABLE
- LI-ION/NI-CAD/NI-MH BATTERY (OTHER CUSTOMIZED)
- BODY MATERIAL METAL
- MORE THAN 1 HOURS DURATION
- STANDARD: CE, ROHS
- 3 YEARS WARRANTY

SPECIFICATIONS

EMERGENCY POWER: 28W MAX
 INPUT VOLTAGE: AC85-265V 50/60HZ
 OUTPUT VOLTAGE: DC180-310V & AC 220V
 BATTERY: 11.1 LI-ION/12V NI-CAD/12V NI-MH BATTERY PACK EXTERNAL
 BODY MATERIAL: METAL
 PRODUCT SIZE: 217*40*30MM

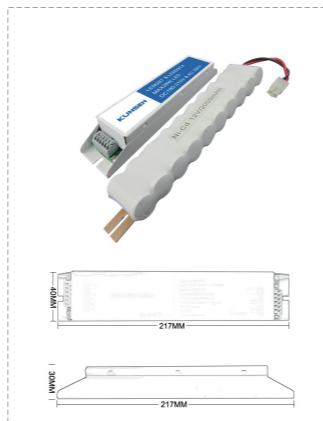

APPLICATIONS

28W MAX LED
 (LED TUBE,LED PANEL,LED DOWN LIGHT,FLUORESCENT LAMP ETC...)

MODEL: LEM40T

FEATURES

- LED INDICATOR & TEST BUTTON EXTERNAL WITH CABLE
- 11.1V/7.4V LI-ION BATTERY (OTHER CUSTOMIZED)
- BODY MATERIAL PLASTIC
- MORE THAN 1 HOURS DURATION
- STANDARD: CE, ROHS
- 3 YEARS WARRANTY

SPECIFICATIONS

EMERGENCY POWER: 40W MAX
 INPUT VOLTAGE: AC85-265V 50/60HZ DUAL INPUT WITH LC
 OUTPUT VOLTAGE: DC 220V
 BATTERY: 11.1V 2500MAH OR 7.4V 2500MAH 18650 EXTERNAL
 BODY MATERIAL: PLASTIC
 PRODUCT SIZE: 100*66*30MM

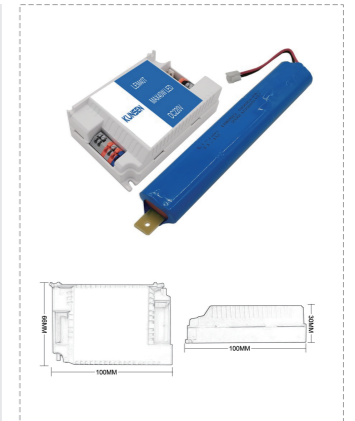

APPLICATIONS

40W MAX LED
 (LED TUBE,LED PANEL,LED DOWN LIGHT,LED TRI-PROOF LIGHT ETC...)

MODEL: LEM50T

FEATURES

- LED INDICATOR & TEST BUTTON EXTERNAL WITH CABLE
- 11.1V LI-ION BATTERY (OTHER CUSTOMIZED)
- BODY MATERIAL PLASTIC
- MORE THAN 1 HOURS DURATION
- STANDARD: CE, ROHS
- 3 YEARS WARRANTY

SPECIFICATIONS

EMERGENCY POWER: 50W MAX
 INPUT VOLTAGE: AC85-265V 50/60HZ
 OUTPUT VOLTAGE: DC 220V
 BATTERY: 11.1V 2500MAH 18650 EXTERNAL
 BODY MATERIAL: PLASTIC
 PRODUCT SIZE: 121*77*30MM

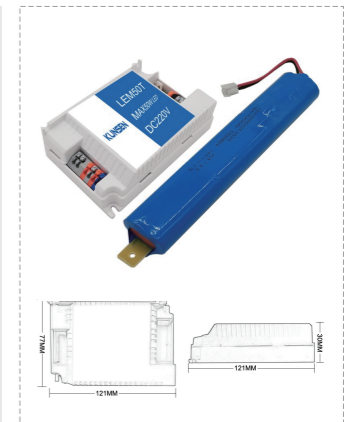

APPLICATIONS

50W MAX LED
 (LED TUBE,LED PANEL,LED DOWN LIGHT,LED TRI-PROOF LIGHT ETC...)

MODEL: LEM160T

FEATURES

- 11.1V LI-ION BATTERY (OTHER CUSTOMIZED)
- BODY MATERIAL PLASTIC & METAL
- MORE THAN 1 HOURS DURATION
- STANDARD: CE, ROHS
- 3 YEARS WARRANTY

SPECIFICATIONS

EMERGENCY POWER: 160W MAX
 INPUT VOLTAGE: AC85-265V 50/60HZ
 OUTPUT VOLTAGE: DC 220V
 BATTERY: 11.1V 12000MAH 18650 EXTERNAL
 BODY MATERIAL: PLASTIC & METAL
 PRODUCT SIZE: 270*200*68MM

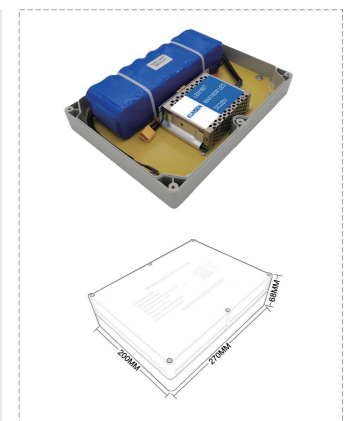

APPLICATIONS

160W MAX LED WITH 220V INPUT VOLTAGE
 (LED PANEL,LED DOWN LIGHT,HIGH BAY ETC...)

MODEL: LEM300T

FEATURES

- 22.2V LI-ION BATTERY (OTHER CUSTOMIZED)
- BODY MATERIAL PLASTIC & METAL
- MORE THAN 1 HOURS DURATION
- STANDARD: CE, ROHS
- 3 YEARS WARRANTY

SPECIFICATIONS

EMERGENCY POWER: 300W MAX
 INPUT VOLTAGE: AC85-265V 50/60HZ
 OUTPUT VOLTAGE: DC 220V
 BATTERY: 22.2V 12000MAH 18650 EXTERNAL
 BODY MATERIAL: PLASTIC & METAL
 PRODUCT SIZE: 365*195*86MM

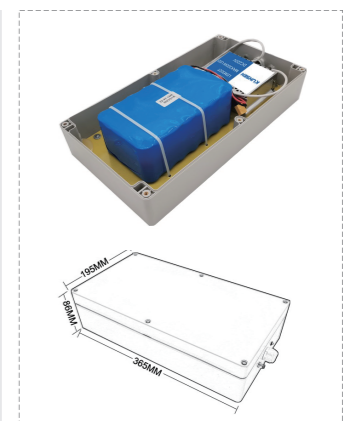

APPLICATIONS

300W MAX LED WITH 220V INPUT VOLTAGE
 (LED PANEL,LED DOWN LIGHT,HIGH BAY ETC...)

全功率应急电源 Full Emergency power battery pack

MODEL: LEM1120A

FEATURES

- LED INDICATOR & TEST BUTTON EXTERNAL WITH CABLE
- 11.1V LI-ION BATTERY (OTHER CUSTOMIZED)
- BODY MATERIAL METAL
- MORE THAN 1 HOURS DURATION
- STANDARD: CE, ROHS
- 3 YEARS WARRANTY

APPLICATIONS

40W MAX LED WITH 220V INPUT VOLTAGE

(LED TUBE, LED PANEL, LED DOWN LIGHT, LED TRI-PROOF LIGHT ETC...)

SPECIFICATIONS

EMERGENCY POWER: 40W MAX
 INPUT VOLTAGE: AC85-265V 50/60HZ
 OUTPUT VOLTAGE: DC 220V
 BATTERY: 11.1V 2500MAH 18650 BUILT IN
 BODY MATERIAL: METAL
 PRODUCT SIZE: 242*40*27MM

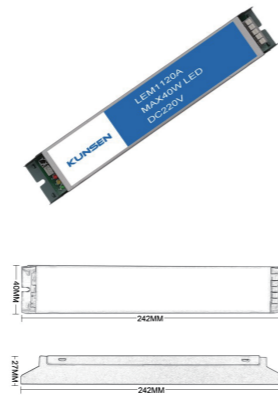

降功率应急电源 Non Full emergency driver

EMERGENCY BATTERY PACKS

MODEL: LEM-J3W-3T

FEATURES

- LED INDICATOR & TEST BUTTON ON PCB (EXTERNAL LED INDICATOR & TEST BUTTON CUSTOMIZED)
- 3.7V LI-ION BATTERY (OTHER CUSTOMIZED)
- BODY MATERIAL PLASTIC
- 3 HOURS RATED DURATION
- STANDARD: CE, ROHS
- 3 YEARS WARRANTY

APPLICATIONS

3-50W LED WITH EXTERNAL DRIVER

(LED PANEL, LED DOWN LIGHT ETC...)

SPECIFICATIONS

EMERGENCY POWER: 3W
 INPUT VOLTAGE: AC85-265V 50/60HZ
 OUTPUT VOLTAGE: DC10-175V
 BATTERY: 3.7V 1200MAH 18650 BUILT IN
 BODY MATERIAL: PLASTIC
 PRODUCT SIZE: 110*42*24MM

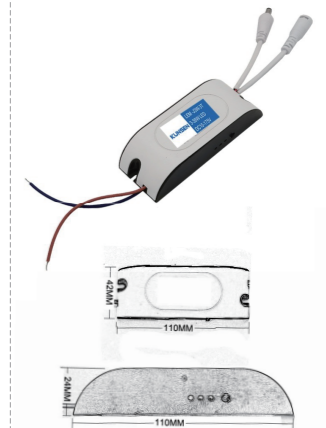

MODEL: LEM100T-2

FEATURES

- 19.2V LIFEPO4 BATTERY (OTHER CUSTOMIZED)
- BODY MATERIAL ALUMINUM
- SIMULATED POWER FAILURE TEST SWITCH
- MORE THAN 1 HOURS DURATION
- STANDARD: CE, ROHS
- 3 YEARS WARRANTY

APPLICATIONS

100W MAX LED WITH 110-240V INPUT VOLTAGE

(LED PANEL, LED DOWN LIGHT, HIGH BAY ETC...)

SPECIFICATIONS

INPUT VOLTAGE: AC110-240V 50/60HZ
 INPUT CURRENT: 13-100MA
 POWER FACTOR: 0.5
 OUTPUT VOLTAGE: DC200-240V
 CHARGE TIME: 24HOURS
 BATTERY CHARGING CURRENT: 0-500MA
 EMERGENCY POWER: 100W MAX
 DURATION: 100W>=60MINUTES
 BATTERY: 19.2V 6000MAH LIFEPO4
 POWER INDICATOR LIGHT: RED
 IP RATE: IP30
 PRODUCT SIZE: 245*62*29MM

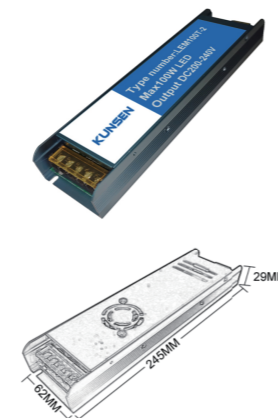

MODEL: LEM-J3WT-5

FEATURES

- LED INDICATOR & TEST BUTTON ON PCB (EXTERNAL LED INDICATOR & TEST BUTTON CUSTOMIZED)
- 3.7V LI-ION BATTERY (OTHER CUSTOMIZED)
- BODY MATERIAL ALUMINUM
- 3 HOURS RATED DURATION
- STANDARD: CE, ROHS
- 3 YEARS WARRANTY

APPLICATIONS

3-50W LED WITH EXTERNAL DRIVER

(LED PANEL, LED DOWN LIGHT ETC...)

SPECIFICATIONS

EMERGENCY POWER: 3W
 INPUT VOLTAGE: AC85-265V 50/60HZ
 OUTPUT VOLTAGE: DC10-180V
 BATTERY: 3.7V 2500MAH 18650 BUILT IN
 BODY MATERIAL: ALUMINUM
 PRODUCT SIZE: 145*40*23MM

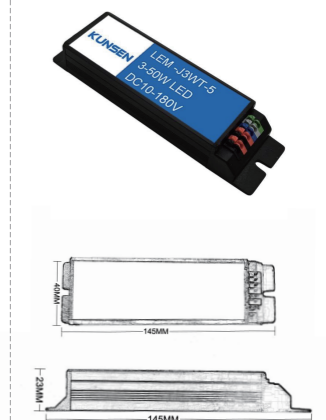

MODEL: LEM200T-2

FEATURES

- 19.2V LIFEPO4 BATTERY (OTHER CUSTOMIZED)
- BODY MATERIAL ALUMINUM
- SIMULATED POWER FAILURE TEST SWITCH
- MORE THAN 1 HOURS DURATION
- STANDARD: CE, ROHS
- 3 YEARS WARRANTY

APPLICATIONS

200W MAX LED WITH 110-240V INPUT VOLTAGE

(LED PANEL, LED DOWN LIGHT, HIGH BAY ETC...)

SPECIFICATIONS

INPUT VOLTAGE: AC110-240V 50/60HZ
 INPUT CURRENT: 13-100MA
 POWER FACTOR: 0.5
 OUTPUT VOLTAGE: DC200-240V
 CHARGE TIME: 24HOURS
 BATTERY CHARGING CURRENT: 0-500MA
 EMERGENCY POWER: 200W MAX
 DURATION: 200W>=60MINUTES
 BATTERY: 19.2V 12000MAH LIFEPO4
 POWER INDICATOR LIGHT: RED
 IP RATE: IP30
 PRODUCT SIZE: 245*62*29MM

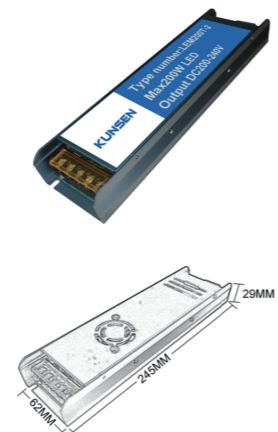

MODEL: LEM-J10WT

FEATURES

- LED INDICATOR & TEST BUTTON EXTERNAL WITH CABLE
- 7.4V LI-ION BATTERY (OTHER CUSTOMIZED)
- BODY MATERIAL PLASTIC
- 3 HOURS RATED DURATION
- STANDARD: CE, ROHS
- 3 YEARS WARRANTY

APPLICATIONS

3-200W LED WITH EXTERNAL DRIVER OR 3-36W LED WITH INTERNAL DRIVER

(LED PANEL, LED DOWN LIGHT, LED TRI-PROOF LAMP, LED TUBE, HIGH BAY, ETC...)

SPECIFICATIONS

EMERGENCY POWER: 3W-5W-8W CONSTANT POWER
 INPUT VOLTAGE: AC85-265V 50/60HZ
 OUTPUT VOLTAGE: DC10-175V
 BATTERY: 7.4V 2500MAH 18650 BUILT IN
 BODY MATERIAL: PLASTIC
 PRODUCT SIZE: 101*66*30MM



降功率应急电源 Non Full emergency driver

MODEL: LEM5P

FEATURES

- LED INDICATOR & TEST BUTTON EXTERNAL WITH CABLE
- 7.4V LI-ION BATTERY (OTHER CUSTOMIZED)
- BODY MATERIAL PLASTIC
- 3 HOURS RATED DURATION
- STANDARD: CE, ROHS
- 3 YEARS WARRANTY

APPLICATIONS

[5-200W LED WITH EXTERNAL DRIVER](#)

(LED PANEL, LED DOWN LIGHT, LED TRI-PROOF LAMP, ETC...)

SPECIFICATIONS

EMERGENCY POWER: 5W CONSTANT POWER
 INPUT VOLTAGE: AC85-265V 50/60HZ DUAL INPUT WITH LC
 OUTPUT VOLTAGE: DC10-175V
 BATTERY: 7.4V 2500MAH 18650 EXTERNAL
 BODY MATERIAL: PLASTIC
 PRODUCT SIZE: 148*40*28MM



MODEL: LEM5W

FEATURES

- LED INDICATOR & TEST BUTTON EXTERNAL WITH CABLE
- 7.4V LI-ION BATTERY (OTHER CUSTOMIZED)
- BODY MATERIAL PLASTIC
- 3 HOURS RATED DURATION
- STANDARD: CE, ROHS
- 3 YEARS WARRANTY

APPLICATIONS

[5-200W LED WITH EXTERNAL DRIVER](#)

(LED PANEL, LED DOWN LIGHT, LED TRI-PROOF LAMP, HIGH BAY, ETC...)

SPECIFICATIONS

EMERGENCY POWER: 5W CONSTANT POWER
 INPUT VOLTAGE: AC85-265V 50/60HZ
 OUTPUT VOLTAGE: DC10-175V
 BATTERY: 7.4V 2500MAH 18650 BUILT IN
 BODY MATERIAL: PLASTIC
 PRODUCT SIZE: 180*41*28MM

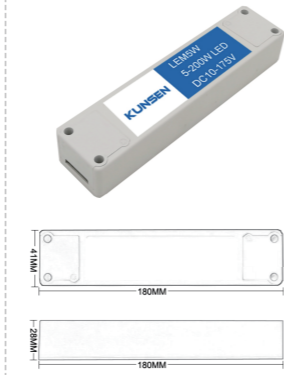

MODEL: LEM10W

FEATURES

- LED INDICATOR & TEST BUTTON EXTERNAL WITH CABLE
- 7.4V LI-ION BATTERY (OTHER CUSTOMIZED)
- BODY MATERIAL PLASTIC
- 3 HOURS RATED DURATION
- STANDARD: CE, ROHS
- 3 YEARS WARRANTY

APPLICATIONS

[3-200W LED WITH EXTERNAL DRIVER OR 3-36W LED WITH INTERNAL DRIVER](#)

(LED PANEL, LED DOWN LIGHT, LED TRI-PROOF LAMP, LED TUBE, HIGH BAY, ETC...)

SPECIFICATIONS

EMERGENCY POWER: 3W-5W-8W
 CONSTANT POWER
 INPUT VOLTAGE: AC85-265V 50/60HZ
 OUTPUT VOLTAGE: DC10-175V
 BATTERY: 7.4V 2500MAH 18650 BUILT IN
 BODY MATERIAL: PLASTIC
 PRODUCT SIZE: 215*41*28MM

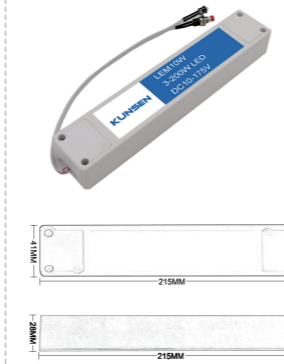

MODEL: LEM15W

FEATURES

- LED INDICATOR & TEST BUTTON EXTERNAL WITH CABLE
- 11.1V LI-ION BATTERY (OTHER CUSTOMIZED)
- BODY MATERIAL PLASTIC
- 3 HOURS RATED DURATION
- STANDARD: CE, ROHS
- 3 YEARS WARRANTY

APPLICATIONS

[5-200W LED WITH EXTERNAL DRIVER](#)

(LED PANEL, LED DOWN LIGHT, LED TRI-PROOF LAMP, HIGH BAY, ETC...)

SPECIFICATIONS

EMERGENCY POWER: 4W-8W-15W
 CONSTANT POWER
 INPUT VOLTAGE: AC85-265V 50/60HZ
 OUTPUT VOLTAGE: DC10-175V
 BATTERY: 11.1V 2500MAH 18650 BUILT IN
 BODY MATERIAL: PLASTIC
 PRODUCT SIZE: 215*41*28MM

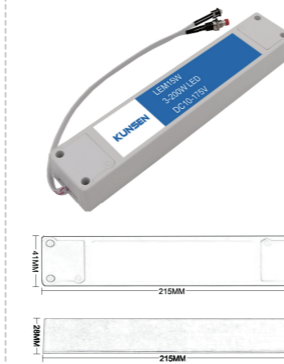

MODEL: LEM20T

FEATURES

- LED INDICATOR & TEST BUTTON ON PCB (EXTERNAL LED INDICATOR & TEST BUTTON CUSTOMIZED)
- 3.7V LI-ION BATTERY (OTHER CUSTOMIZED)
- BODY MATERIAL PLASTIC
- 3 HOURS RATED DURATION
- STANDARD: CE, ROHS
- 3 YEARS WARRANTY

APPLICATIONS

[MAX 18W GU10](#)

(LED TUBE, GU10 ETC...)

SPECIFICATIONS

EMERGENCY POWER: 3W
 INPUT VOLTAGE: AC85-265V 50/60HZ
 OUTPUT VOLTAGE: DC10-180V
 BATTERY: 3.7V 1200MAH 18650 BUILT IN
 BODY MATERIAL: PLASTIC
 PRODUCT SIZE: 190*28*22MM

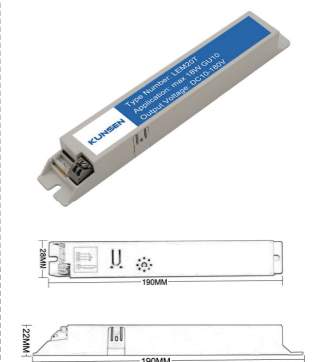

MODEL: LEM20W

FEATURES

- WATERPROOF LED INDICATOR & TEST BUTTON EXTERNAL WITH CABLE
- 11.1V LI-ION BATTERY (OTHER CUSTOMIZED)
- BODY MATERIAL ALUMINUM
- MORE THAN 2 HOURS DURATION
- STANDARD: CE, ROHS
- 3 YEARS WARRANTY

APPLICATIONS

[10-200W LED WITH EXTERNAL DRIVER](#)

(LED PANEL, LED DOWN LIGHT, LED TUBELED TRI-PROOF LIGHT, ETC...)

SPECIFICATIONS

EMERGENCY POWER: 20W MAX
 INPUT VOLTAGE: AC110-240V 50/60HZ
 OUTPUT VOLTAGE: DC 30-175V
 BATTERY: 11.1V 2500MAH LI-ION 18650 BUILT IN
 BODY MATERIAL: ALUMINUM
 PRODUCT SIZE: 275*75*42MM

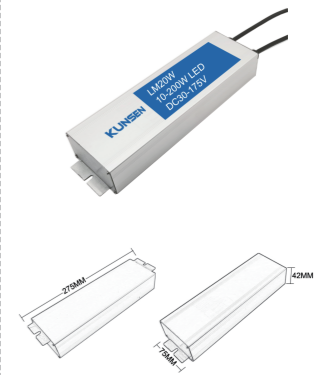

MODEL: LEM24P

FEATURES

- EMERGENCY MODULE WITH OUT DRIVER
- 3.7V LI-ION BATTERY (OTHER CUSTOMIZED)
- BODY MATERIAL PLASTIC WITH CABLE
- MORE THAN 90 MINUTES DURATION
- STANDARD: CE, ROHS
- 1 YEARS WARRANTY

APPLICATIONS

[3-24W LED CEILING LIGHT DRIVER](#)

(LED PANEL, LED DOWN LIGHT ETC...)

SPECIFICATIONS

EMERGENCY POWER: 3W
 INPUT VOLTAGE: AC85-265V 50/60HZ
 OUTPUT VOLTAGE: DC10-175V
 BATTERY: 3.7V 1200MAH 18650 BUILT IN
 BODY MATERIAL: PLASTIC WITH CABLE
 PRODUCT SIZE: Φ75*25MM

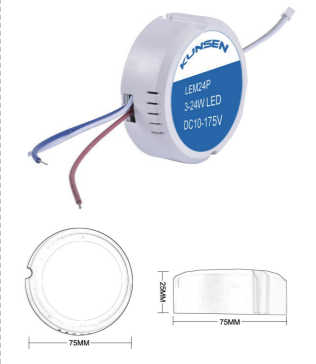

MODEL: LEM032C002P

FEATURES

- WITH DC PLUG
- 3.7V LI-ION BATTERY (OTHER CUSTOMIZED)
- BODY MATERIAL PLASTIC
- 90-120 MINUTES DURATION
- STANDARD: CE, ROHS
- 3 YEARS WARRANTY

APPLICATIONS

[5-200W LED WITH EXTERNAL DRIVER](#)

(LED PANEL, LED DOWN LIGHT, LED TRI-PROOF LAMP, HIGH BAY, ETC...)

SPECIFICATIONS

EMERGENCY POWER: 3W
 INPUT VOLTAGE: AC85-265V 50/60HZ
 EMERGENCY LUMEN: 30%
 BATTERY: 3.7V 2400MAH 18650 BUILT IN
 BODY MATERIAL: PLASTIC
 PRODUCT SIZE: 130*45*25MM

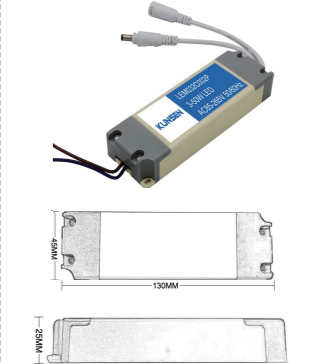

降功率应急电源 Non Full emergency driver

MODEL: LEM042C015P

FEATURES

- LED INDICATOR & TEST BUTTON EXTERNAL WITH CABLE
- 7.4V LI-ION BATTERY (OTHER CUSTOMIZED)
- BODY MATERIAL PLASTIC
- MORE THAN 1 HOURS DURATION
- STANDARD: CE, ROHS
- 3 YEARS WARRANTY

SPECIFICATIONS

LED DRIVER OUTPUT CURRENT: 2A MAX
 INPUT VOLTAGE: AC110-250V 50/60HZ
 OUTPUT VOLTAGE: DC 10-300V
 BATTERY: 7.4V LI-ION 18650 EXTERNAL
 BODY MATERIAL: PLASTIC
 PRODUCT SIZE: 200*19*22MM



APPLICATIONS

100W MAX LED WITH EXTERNAL DRIVER

(LED PANEL, LED DOWN LIGHT, LED TRI-PROOF LIGHT HIGH BAY, ETC...)

MODEL: LEM72P

FEATURES

- LED INDICATOR & TEST BUTTON EXTERNAL WITH CABLE
- NI-CAD, NI-MH, LI-ION BATTERY (OTHER CUSTOMIZED)
- BODY MATERIAL PLASTIC
- 3 HOURS RATED DURATION
- STANDARD: CE, ROHS
- 3 YEARS WARRANTY

SPECIFICATIONS

EMERGENCY POWER: 20-600MA CONSTANT OUTPUT CURRENT
 INPUT VOLTAGE: AC85-265V 50/60HZ
 OUTPUT VOLTAGE: DC3-100V
 BATTERY: NI-CAD, NI-MH, LI-ION 18650
 BATTERY PACK EXTERNAL
 BODY MATERIAL: PLASTIC
 PRODUCT SIZE: 155*40*30MM

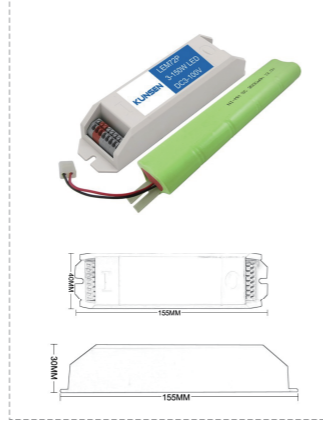

APPLICATIONS

3-150W LED WITH EXTERNAL DRIVER

(LED PANEL, LED DOWN LIGHT, LED TRI-PROOF LAMP, HIGH BAY, ETC...)

MODEL: LEM102C020T

FEATURES

- LED INDICATOR & TEST BUTTON ON PCB (EXTERNAL LED INDICATOR & TEST BUTTON CUSTOMIZED)
- 3.7V LI-ION BATTERY (OTHER CUSTOMIZED)
- BODY MATERIAL PLASTIC
- 3 HOURS RATED DURATION
- STANDARD: CE, ROHS
- 3 YEARS WARRANTY

SPECIFICATIONS

EMERGENCY POWER: 3W
 INPUT VOLTAGE: AC85-265V 50/60HZ
 OUTPUT VOLTAGE: DC10-180V
 BATTERY: 3.7V 1200MAH 18650 BUILT IN
 BODY MATERIAL: PLASTIC
 PRODUCT SIZE: 150*30*25MM

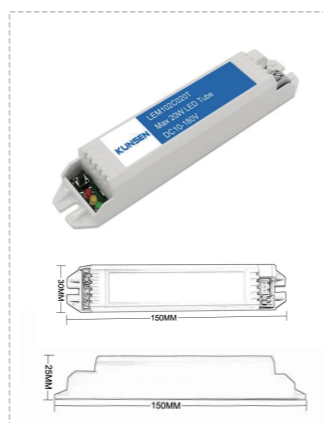

APPLICATIONS

MAX 20W LED TUBE

(LED PANEL, LED DOWN LIGHT, LED TRI-PROOF LIGHT HIGH BAY, ETC...)

MODEL: LEM1115A

FEATURES

- LED INDICATOR & TEST BUTTON EXTERNAL WITH CABLE
- 6.4V/9.6V LIFEPO4, 7.4V/11.1V LI-ION BATTERY (OTHER CUSTOMIZED)
- BODY MATERIAL METAL
- 3 HOURS RATED DURATION
- STANDARD: CE, ROHS
- 3 YEARS WARRANTY

SPECIFICATIONS

EMERGENCY POWER: 15W CONSTANT POWER
 INPUT VOLTAGE: AC85-265V 50/60HZ
 OUTPUT VOLTAGE: DC10-180V
 BATTERY: 6.4V 2500MAH/9.6V 2500MAH LIFEPO4,
 7.4V 2500MAH/11.1V 2500MAH 18650 EXTERNAL
 BODY MATERIAL: METAL
 PRODUCT SIZE: 207*33*26MM



APPLICATIONS

15-200W LED WITH EXTERNAL DRIVER

(LED PANEL, LED DOWN LIGHT, LED TRI-PROOF LAMP, HIGH BAY, ETC...)

MODEL: LEM3648A

FEATURES

- LED INDICATOR & TEST BUTTON ON PCB (EXTERNAL LED INDICATOR & TEST BUTTON CUSTOMIZED)
- 7.4V LI-ION BATTERY (OTHER CUSTOMIZED)
- BODY MATERIAL ALUMINUM
- 3 HOURS RATED DURATION
- STANDARD: CE, ROHS
- 3 YEARS WARRANTY

SPECIFICATIONS

EMERGENCY POWER: 5W
 INPUT VOLTAGE: AC85-265V 50/60HZ
 OUTPUT VOLTAGE: DC10-180V
 BATTERY: 7.4V 2500MAH 18650 BUILT IN
 BODY MATERIAL: ALUMINUM
 PRODUCT SIZE: 212*40*23MM

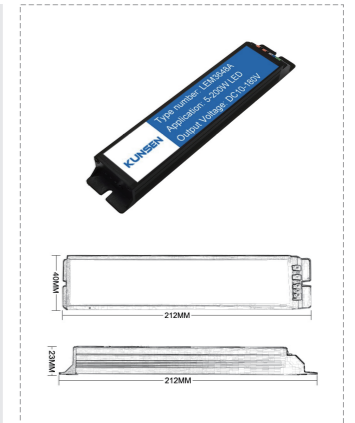

APPLICATIONS

5-200W LED WITH EXTERNAL DRIVER

(LED PANEL, LED DOWN LIGHT, LED TRI-PROOF LAMP, ETC...)

MODEL: LEM3-50W

FEATURES

- LED INDICATOR & TEST BUTTON ON PCB (EXTERNAL LED INDICATOR & TEST BUTTON CUSTOMIZED)
- 3.7V LI-ION BATTERY (OTHER CUSTOMIZED)
- BODY MATERIAL ALUMINUM
- MORE THAN 2 HOURS DURATION
- STANDARD: CE, ROHS
- 3 YEARS WARRANTY

SPECIFICATIONS

EMERGENCY POWER: 3W
 INPUT VOLTAGE: AC85-265V 50/60HZ
 OUTPUT VOLTAGE: DC10-175V
 BATTERY: 3.7V 2400MAH 18650 BUILT IN
 BODY MATERIAL: ALUMINUM
 PRODUCT SIZE: 121*56*20MM

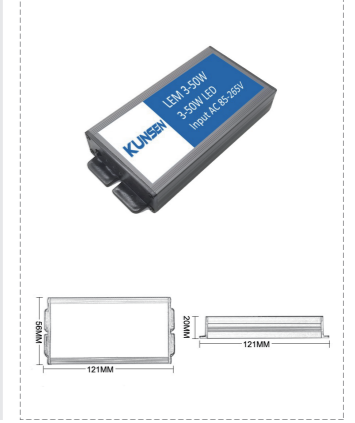

APPLICATIONS

3-50W LED WITH EXTERNAL DRIVER

(LED PANEL, LED DOWN LIGHT ETC...)

MODEL: LEM803P

FEATURES

- LED INDICATOR & TEST BUTTON EXTERNAL WITH CABLE
- LI-ION BATTERY (OTHER CUSTOMIZED)
- BODY MATERIAL PLASTIC
- 3 HOURS RATED DURATION
- STANDARD: CE, ROHS
- 3 YEARS WARRANTY

SPECIFICATIONS

EMERGENCY POWER: 20W OR 30W
 INPUT VOLTAGE: AC85-265V 50/60HZ
 OUTPUT VOLTAGE: DC20-56V
 BATTERY: 11.1V 6600MAH 18650 EXTERNAL
 BODY MATERIAL: PLASTIC
 PRODUCT SIZE: 169*41*29MM

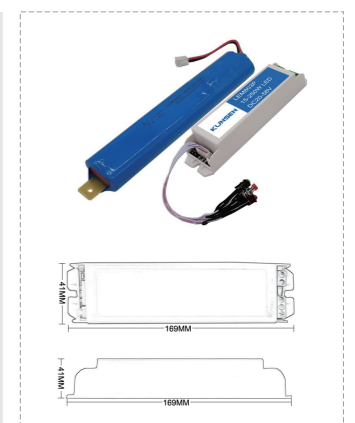

APPLICATIONS

20-250W LED WITH EXTERNAL DRIVER

(LED PANEL, LED DOWN LIGHT, HIGH BAY, ETC...)

MODEL: LEM-4505WT

FEATURES

- LED INDICATOR & TEST BUTTON EXTERNAL WITH CABLE
- 3.7V LI-ION BATTERY (OTHER CUSTOMIZED)
- BODY MATERIAL PLASTIC
- MORE THAN 3 HOURS DURATION
- STANDARD: CE, ROHS
- 3 YEARS WARRANTY

SPECIFICATIONS

EMERGENCY POWER: 5W
 INPUT VOLTAGE: AC100-240V 50/60HZ
 NORMAL OUTPUT 1: DC12V 20W
 NORMAL OUTPUT 2: DC12V 20W
 EMERGENCY OUTPUT: DC12V
 BATTERY: 3.7V 5000MAH 18650 EXTERNAL
 BODY MATERIAL: PLASTIC
 PRODUCT SIZE: 122*78*32MM

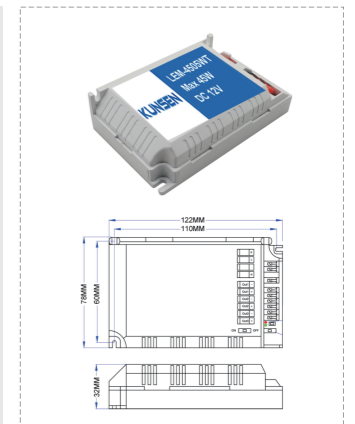

APPLICATIONS

20W MAX LED STRIP

(LED STRIP ETC...)